

Pricelist

GB 2014 EURO
Valid from 01.01.2014



Hydronic system control units for your daily work
System units • System components • Accessories • Spare parts

SWEDISH EXPERTISE

WHO WOULD YOU CONSULT ABOUT HEATING IF NOT A SWEDE?

Living in Europe's most northerly corner our climate gives us reason to care about heating almost year round. And we know to appreciate it to both work reliably and not wasting any energy unnecessarily.

As for Swedish reliability and quality it's been ESBEs second nature ever since we launched our first "Schwedenmischer*" in the mid 1930's.

Today we use the most advanced technology available, to control heating efficiently as well as to ensure the quality within our production lines.

* =Nickname for mixing valve type introduced by ESBEs revolutionary model in the 60's.



General terms of delivery

Delivery terms: FCA REFELE Sweden, according to Incoterms 2010.
Payment terms: 30 days net. After due date interest will be charged.
Delivery terms: Orgalime S2000

Other conditions: As per agreement
Price alterations: We reserve the right to revise prices at essential changes in market and exchange conditions.

CONTENTS

ESBE PRICELIST 2014



1. CIRCULATION UNITS 4-5



2. ROTARY VALVES 5-7



3. ROTARY ACTUATORS 8-9



4. ROTARY UNITS 9



5. CONTROLLERS 10-11



6. CONTROLLER UNITS 11

**7. ADAPTOR KIT GUIDE 12-13
SELECTION GUIDE 14**



8. SOLID FUEL PRODUCTS 15-17



9. DIVERTING VALVES 18



10. THERMOSTATIC UNITS 19



**11. THERMOSTATIC
MIXING VALVES 20-23**



**12. LINEAR MOTORIZED
VALVES 23-27**



**13. COMPLEMENTARY
PRODUCTS 27-28**

14. SPARE PARTS 29-39

15. INDEX 40-42

16. REPLACEMENT GUIDE 43

CIRCULATION UNITS



NEW!
A BRAND
NEW PRODUCT
SEGMENT



CIRCULATION UNIT

Mixing function
Series GRC, GRA

GRC211

With Controller 90C-1 ready and mounted on the Circulation unit. PN6.

Art. No. _____ 61040300
DN _____ 25
Euro/pcs _____ 1150,00

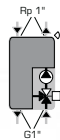
**GRC111**

With Controller CRC100 ready and mounted on the Circulation unit. PN6.

Art. No. _____ 61040200
DN _____ 25
Euro/pcs _____ 890,00

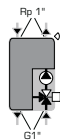
**GRA111**

With Actuator ARA661, 230V 3-point ready and mounted on the Circulation unit. PN6.

Art. No. _____ 61040100
DN _____ 25
Euro/pcs _____ 720,00

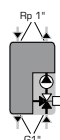
**CIRCULATION UNIT**

Direct supply
Series GDA

GDA111

Circulation unit intended for direct supply of heating. PN6.

Art. No. _____ 61000100
DN _____ 25
Euro/pcs _____ 450,00

**CIRCULATION UNIT**

Fixed temperature
Series GFA

GFA111

Circulation unit intended for fixed temperature operation. PN6.

Art. No. _____ 61020100
DN _____ 25
Temperature range _____ 20-43°C
Euro/pcs _____ 580,00

**CIRCULATION UNIT**

Bivalent function
Series GBC, GBA

GBC211

With Controller 90C-3 ready and mounted on the Circulation unit. PN6.

Art. No. _____ 61060200
DN _____ 25
Euro/pcs _____ 1500,00

**GBA111**

With Actuator ARA661, 230V 3-point ready and mounted on the Circulation unit. PN6.

Art. No. _____ 61060100
DN _____ 25
Euro/pcs _____ 762,00

**Further technical information**

On our website you will find loads of useful information like instruction manuals, certificates and technical data. You also might discover some additional article numbers.

Scan the QR-code and go to address
<http://www.esbe.eu/gb/en/products>



ESBE ACCESSORIES
MANIFOLD

GMA121

Manifold for 2 circulation units, without integrated separator function. PN4.

Art. No. _____ 6600 01 00
Connections _____ To system : RN 1 1/2"
_____ From Heat source : G 1 1/2"
Euro/pcs _____ 285,00



GMA131

Manifold for 3 units, without integrated separator function. PN4.

Art. No. _____ 66000200
Connections _____ To system : RN 1 1/2"
_____ From Heat source : G 1 1/2"
Euro/pcs _____ 350,00



GMA221

Manifold for 2 units, with integrated separator function. PN4.

Art. No. _____ 6600 03 00
Connections _____ To system : RN 1 1/2"
_____ From Heat source : G 1 1/2"
Euro/pcs _____ 480,00



GMA231

Manifold for 3 units, with integrated separator function. PN4.

Art. No. _____ 66000400
Connections _____ To system : RN 1 1/2"
_____ From Heat source : G 1 1/2"
Euro/pcs _____ 650,00



MANIFOLD CONNECTIONS

KGR111

ESBE Manifold connection for units GDA, GRA, GRC, GBA and GBC. (2 connections/package). PN10.

Art. No. _____ 66100200
Connection _____ For Circulation Unit : Rp 1"
_____ For Manifold : G 1 1/2"
Euro/pcs _____ 26,00



KGT111

ESBE Manifold connection for fixed temperature unit GFA. (2 connections/package). PN10.

Art. No. _____ 66100100
Connection _____ For Circulation Unit : Rp 1"
_____ For Manifold : G 1 1/2"
Euro/pcs _____ 26,00



ESBE SYSTEM COMPONENTS
ROTARY VALVES

MIXING VALVE
Series VRG130

VRG131

Internal thread, PN10



Art. No.	DN	Kvs	Connection	Euro/pcs
11600100	15	0.4	Rp 1/2"	59,00
11600200		0.63		59,00
11600300		1		59,00
11600400		1.6		59,00
11600500		2.5		59,00
11600600		4		59,00
11600700	20	2.5	Rp 3/4"	56,00
11600800		4		56,00
11600900		6.3		56,00
11601000	25	6.3	Rp 1"	60,00
11601100		10		60,00
11601200	32	16	Rp 1 1/4"	68,00
11603400	40	25	Rp 1 1/2"	99,00
11603600	50	40	Rp 2"	147,00

VRG132

External thread, PN10



Art. No.	DN	Kvs	Connection *	Euro/pcs
11601500	15	0.4	G 3/4"	59,00
11601600		0.63		59,00
11601700		1		59,00
11601800		1.6		59,00
11601900		2.5		59,00
11602000		4		59,00
11602100	20	2.5	G 1"	56,00
11602200		4		56,00
11602300		6.3		56,00
11602400	25	6.3	G 1 1/4"	60,00
11602500		10		60,00
11602600	32	16	G 1 1/2"	68,00
11603500	40	25	G 2"	99,00
11603700	50	40	G 2 1/4"	147,00

Notes: * The matching connection kit for your valve can be found on page 7.



ESBE SYSTEM COMPONENTS

ROTARY VALVES

MIXING VALVE

Series VRG130



VRG133
Compression fitting, PN10

Art. No.	DN	Kvs	Connection	Euro/pcs
11602900	20	4	CPF 22 mm	63,00
11603000		6.3		68,00
11603100	25	10	CPF 28 mm	101,00

MIXING VALVE

Series VRG140

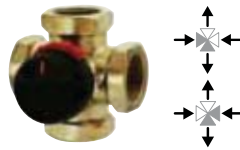

VRG141
Internal thread, PN10

Art. No.	DN	Kvs	Connection	Euro/pcs
11640100	15	2.5	Rp 1/2"	61,00
11640200	20	4	Rp 3/4"	61,00
11640300		6.3		61,00
11640400	25	10	Rp 1"	67,00
11640500	32	16	Rp 1 1/4"	74,00
11641500	40	25	Rp 1 1/2"	121,00
11641700	50	40	Rp 2"	179,00

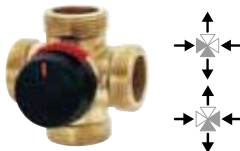

VRG142
External thread, PN10

Art. No.	DN	Kvs	Connection *	Euro/pcs
11640800	15	2.5	G 3/4"	61,00
11640900	20	4	G 1"	61,00
11641000		6.3		61,00
11641100	25	10	G 1 1/4"	67,00
11641200	32	16	G 1 1/2"	74,00
11641600	40	25	G 2"	121,00
11641800	50	40	G 2 1/4"	179,00

MIXING VALVE

Series VRH130



VRH131
External thread
+ Pump flange, PN10

Art. No.	DN	Kvs	Connections	Euro/pcs
11720100	25	2.5	G 1 1/2" + PF 1 1/2"	133,00
11720200		4		133,00
11720300		6.3		133,00

CHANGE-OVER / DIVERTING VALVE

Series VRG230

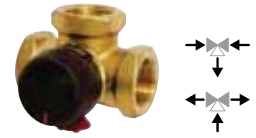

VRG231
Internal thread, PN10

Art. No.	DN	Kvs	Connection	Euro/pcs
11620100	20	6.3	Rp 3/4"	56,00
11620200	25	10	Rp 1"	59,00
11620300	32	16	Rp 1 1/4"	68,00
11621400	40	30	Rp 1 1/2"	99,00
11621600	50	40	Rp 2"	147,00



VRG232
External thread, PN10

Art. No.	DN	Kvs	Connection *	Euro/pcs
11620600	20	6.3	G 1"	56,00
11620700	25	10	G 1 1/4"	59,00
11620800	32	16	G 1 1/2"	68,00
11621500	40	30	G 2"	99,00
11621700	50	40	G 2 1/4"	147,00



VRG233
Compression fitting, PN10

Art. No.	DN	Kvs	Connection	Euro/pcs
11621100	20	4	CPF 22 mm	63,00
11621200		6.3		68,00
11621300	25	10	CPF 28 mm	96,00

MIXING VALVE

Series VRG330



VRG331
Internal thread, PN10

Art. No.	DN	Kvs ■ - ▲	Kvs ■ - ●	Connection	Euro/pcs
11700100	20	13	8	Rp 3/4"	56,00
11700200	25	17	10	Rp 1"	60,00
11700300	32	32	20	Rp 1 1/4"	68,00
11701100	40	45	30	Rp 1 1/2"	105,00
11701300	50	65	40	Rp 2"	147,00



VRG332
External thread, PN10

Art. No.	DN	Kvs ■ - ▲	Kvs ■ - ●	Connection *	Euro/pcs
11700600	20	13	8	G 1"	56,00
11700700	25	17	10	G 1 1/4"	60,00
11700800	32	32	20	G 1 1/2"	68,00
11701200	40	45	30	G 2"	105,00
11701400	50	65	40	G 2 1/4"	147,00

Notes: * The matching connection kit for your valve can be found on page 7.

BIVALENT MIXING VALVE

Series VRB140

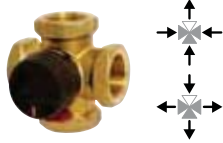

VRB141

Internal thread, PN10

Art. No.	DN	Kvs	Connection	Euro/pcs
11660100	15	2.5	Rp 1/2"	99,00
11660200	20	4	Rp 3/4"	99,00
11660300		6.3		99,00
11660400	25	10	Rp 1"	105,00
11660500	32	16	Rp 1 1/4"	115,00
11662000	40	25	Rp 1 1/2"	152,00
11662200	50	35	Rp 2"	213,00

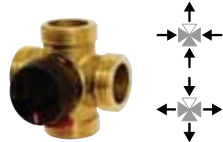

VRB142

External thread, PN10

Art. No.	DN	Kvs	Connection *	Euro/pcs
11660800	15	2.5	G 3/4"	99,00
11662400		4		99,00
11660900	20	4	G 1"	99,00
11661000		6.3		99,00
11661100	25	10	G 1 1/4"	105,00
11661200	32	16	G 1 1/2"	115,00
11662100	40	25	G 2"	152,00
11662300	50	35	G 2 1/4"	213,00

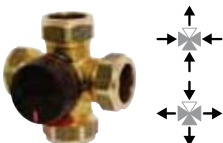

VRB143

Compression fitting, PN10

Art. No.	DN	Kvs	Connection	Euro/pcs
11661500	20	4	CPF 22 mm	108,00
11661600		6.3		108,00
11661700	25	6.3	CPF 28 mm	132,00

Further technical information

On our website you will find loads of useful information like instruction manuals, certificates and technical data. You also might discover some additional article numbers.

Scan the QR-code and go to address <http://www.esbe.eu/gb/en/products>



MIXING VALVE

Series 5MG



5MG

Internal thread, PN10

Art. No.	DN	Kvs	Connection	Euro/pcs
11005200	25	8	Rp 1"	116,00
11005300	32	18	Rp 1 1/4"	141,00

MIXING VALVE

Series 3F and 4F



3F

Flange, PN6

Art. No.	DN	Kvs	Euro/pcs
11100100	20	12	137,00
11100200	25	18	136,00
11100300	32	28	177,00
11100400	40	44	188,00
11100600	50	60	242,00
11100800	65	90	281,00
11101000	80	150	390,00
11101200	100	225	494,00
11101400	125	280	659,00
11101600	150	400	891,00



4F

Flange, PN6

Art. No.	DN	Kvs	Euro/pcs
11101700	32	28	211,00
11101800	40	44	265,00
11101900	50	60	363,00
11102000	65	90	402,00
11102100	80	150	484,00
11102200	100	225	658,00
11102300	125	280	1.057,00
11102400	150	400	1.381,00

ESBE ACCESSORIES

CONNECTION KIT

Series KTD100



KTD112

External thread
(3 connections/package)

Art. No.	Valve thread	Connection thread	Euro/pcs
36551700	G 1"	R 3/4"	14,00
36551800	G 1 1/4"	R 1"	23,00
36551900	G 1 1/2"	R 1 1/4"	30,00
36552000	G 2"	R 1 1/2"	65,00
36552100	G 2 1/4"	R 2"	107,00

INSULATION SHELL

Series VRI100



VRI111

Art. No.	DN	Euro/pcs
16103800	15/20	14,00
16103900	25	15,00
16104000	32	24,00
16104100	40	30,00

Notes: * The matching connection kit for your valve can be found on page 7.

ESBE SYSTEM COMPONENTS
ROTARY ACTUATORS



ACTUATOR
 Series ARA600



3-point/ 2-point/Proportional

3-point, auxiliary switch/
 2-point, auxiliary switch

ARA600
 3-point, 24 V AC

Art. No.	Reference	Running time 90° [s]	Torque [Nm]	Note	Euro/pcs
12100100	ARA643	30	6		152,00
12100200	ARA653	60			152,00
12100700	ARA654			1)	176,00
12100300	ARA663	120			152,00
12100800	ARA664			1)	176,00
12100400	ARA673			240	152,00
12100500	ARA693	120/240/ 480/1200			176,00

ARA600
 3-point, 230 V AC

Art. No.	Reference	Running time 90° [s]	Torque [Nm]	Note	Euro/pcs
12101100	ARA641	30	6		152,00
12101600	ARA642			1)	176,00
12101200	ARA651	60		1)	152,00
12101700	ARA652			1)	176,00
12101300	ARA661	120			152,00
12101800	ARA662			1)	176,00
12101400	ARA671	240			152,00
12101900	ARA672		1)	176,00	
12101500	ARA691	120/240/ 480/1200		176,00	

Further technical information

On our website you will find loads of useful information like instruction manuals, certificates and technical data. You also might discover some additional article numbers.

Scan the QR-code and go to address <http://www.esbe.eu/gb/en/products>



ARA600
 2-point*, 24 V AC

Art. No.	Reference	Running time 90° [s]	Torque [Nm]	Note	Euro/pcs
12120100	ARA637	15	3	2)	176,00
12120200	ARA647	30	6		176,00
12120600	ARA658	60	6	1)	193,00

ARA600
 2-point*, 230 V AC

Art. No.	Reference	Running time 90° [s]	Torque [Nm]	Note	Euro/pcs
12120700	ARA635	15	3	2)	176,00
12121000	ARA636			1), 2)	193,00
12120800	ARA645	30	6		176,00
12121100	ARA646			1)	193,00
12120900	ARA655	60			176,00
12121200	ARA656			1)	193,00

ARA600
 Proportional**, 24 V AC/DC

Art. No.	Reference	Running time 90° [s]	Torque [Nm]	Note	Euro/pcs
12520100	ARA639	15/30/ 60/120	6	3)	189,00
12520200	ARA659	45/120			176,00

ESBE ACCESSORIES

**AUXILIARY SWITCH,
 ADAPTOR KITS**



Options ARA600

Art. No.	Reference	Designation	Euro/pcs
16200700	ARA801	Auxiliary switch kit ARA600	30,00
Different adaptor kits suitable - see pages 12-13.			

Notes: * 2-point SPST = Single Pole Single Throw ** 0..10 V, 2..10 V, 0..20mA, 4..20mA 1) With pre-mounted auxiliary switch 2) Recommended only for valves DN 15-32 3) Auxiliary switch is not possible 4) Separate auxiliary switch as option 5) With pre-mounted auxiliary switch 6) With built-in relay 7) Operating range 270° + Running time 270° - 150s [preset]

ACTUATOR Series 90



90
3-point, 24 V AC

Art. No.	Reference	Running time 90° [s]	Torque [Nm]	Note	Euro/pcs
12050200	91	15	5	4)	179,00
12050600	92	60	15	4)	179,00
12051100	92M			5)	203,00
12050700	92-2	120		4)	179,00
12051300	93	240		4)	179,00

90
3-point, 230 V AC

Art. No.	Reference	Running time 90° [s]	Torque [Nm]	Note	Euro/pcs
12051700	94	15	5	4)	179,00
12051800	94M			5)	203,00
12051900	95	60	15	4)	179,00
12052200	95M			5)	203,00
12052000	95-2	120	15	4)	179,00
12052100	95-2M			5)	203,00
12053300	95-270M	50	5	5), 7)	222,00
12052300	96	240	15	4)	179,00
12052400	96M			5)	203,00

90
2-point*, 230 V AC

Art. No.	Reference	Running time 90° [s]	Torque [Nm]	Note	Euro/pcs
12052500	97	15	5	6)	222,00
12052600	98	60	15		222,00

90
Proportional**, 24 V AC/DC

Art. No.	Reference	Running time 90° [s]	Torque [Nm]	Note	Euro/pcs
12550100	92P	60/90 /120	15	3), Operating range 90°	334,00
12550200	92P2	120/180 /240		3), Operating range 180°	337,00
12550400	92P4	120/240 /360		3), Operating range 355°	361,00

ESBE ACCESSORIES AUXILIARY SWITCH, ADAPTOR KITS



Options 90

Art. No.	Reference	Designation	Euro/pcs
98100690		Separate Auxiliary switch, 90	37,00
		Different adaptor kits suitable – see pages 12-13.	

ESBE SYSTEM COMPONENTS ROTARY UNITS



VRG131 + ARA661
Mixing valve PN10 + Actuator 3-point, 230 V AC

Art. No.	Mixing valve			Actuator	Euro/pcs
	DN	Kvs	Connection		
13020600	15	2.5	Rp 1/2"	ARA661	202,00
13020700	20	4	Rp 3/4"		199,00
13022300		6.3			199,00
13020800	25	6.3	Rp 1"		203,00
13022400		10			203,00



VRG232 + ARA645
Change-over/Diverting valve PN10 + Actuator 2-point, 230 V AC

Art. No.	Mixing valve			Actuator	Euro/pcs
	DN	Kvs	Connection		
13023500	25	10	G 1 1/4"	ARA645	224,00
13023600	32	16	G 1 1/2"		233,00
13023700	40	30	G 2"		261,00



EXCHANGE SET

Serie 90 on existing Centra mixing valve
Actuator 95-2, 230 V AC + Adaptor kit 900C

As a replacement set to an actuator Honeywell VMM20 mounted on a Centra mixing valve ZR/DR/DRG DN15-50; DRU DN25-32. Valid for installations from year 1990.

Art. No.	Actuator	Adaptor kit, 900C	Euro/pcs
12050500	95-2	Centra ZR, DR, DRU, DRG (≤ DN50)	195,00

Notes: * 2-point SPST = Single Pole Single Throw ** 0..10 V, 2..10 V, 0..20mA, 4..20mA 1) With premounted auxiliary switch 2) Recommended only for valves DN 15-32 3) Auxiliary switch is not possible 4) Separate auxiliary switch as option 5) With premounted auxiliary switch 6) With built-in relay 7) Operating range 270° + Running time 270° - 150s (preset)

ESBE SYSTEM COMPONENTS CONTROLLERS



Further technical information

On our website you will find loads of useful information like instruction manuals, certificates and technical data. You also might discover some additional article numbers.

Scan the QR-code and go to address <http://www.esbe.eu/gb/en/products>



CONTROLLER Series 90C



90C

Weather compensation controller, 230 V AC

Hardware 90C

● = included

○ = option, included in versions "C"

□ = option, included in versions "A" + "C"



Hardware	Version		
	90C-1	90C-2	90C-3
Power supply cable (230V), 1.5 m	●	●	●
Pump / Heat source power supply cable (230V), 1.5 m	●		
Sensor box	1	2	2
max. no. of input sources	5	6	7
max. no. of output sources	1	3	3
Flow pipe sensor, 1.5 m cable	●	●	●
Universal sensor, 1.0 m cable (pcs)		2	3
Outdoor sensor (without cable)	●	●	●
Room sensor (without cable)	○	○	○
Sensor cable, 20m	□	□	□

Art. No.	Reference	Torque [Nm]	Note	Euro/pcs
12601100	90C-1A			629,00
12601200	90C-1B	15	1)	607,00
12601300	90C-1C			712,00
12602100	90C-2A			729,00
12602200	90C-2B	15		705,00
12602300	90C-2C			810,00
12603100	90C-3A			733,00
12603200	90C-3B	15		710,00
12603300	90C-3C			810,00

SENSORS, ADAPTOR KITS



Options 90C

Art. No.	Reference	Designation	Euro/pcs
17050700	CRS231	Room sensor	108,00
17050800	CRS211	Flow pipe sensor	41,00
17050900	CRS213	Universal sensor	41,00
17051100	CRS215	High temperature sensor	108,00
		Different adaptor kits suitable - see pages 12-13.	

CONTROLLER Series CRA



CRA11x



CRA12x

CRA

Constant temperature controller, Temp. range 5-95°C



Art. No.	Reference	Voltage [VAC]	Torque [Nm]	Note	Euro/pcs
12720100	CRA111	230	6	4)	305,00
12720500	CRA115				305,00
12720200	CRA112	24			305,00
12742100	CRA121	230	15	4)	398,00
12742500	CRA125				398,00
12742200	CRA122	24			398,00

CONTROLLER Series CRB



CRB11x



CRB12x

CRB

Indoor sensor based controller, 230 V AC



Art. No.	Reference	Torque [Nm]	Room display unit	Note	Euro/pcs
12660100	CRB111	6	Cable	2)	405,00
12661400	CRB114			3) 5)	467,00
12662200	CRB122		Wireless	6)	535,00
12662500	CRB125			4)	535,00

Notes: 1) Replaces 12600100 (95C) 2) Without internal timer 3) With pump control wire box 4) With UK socket 5) Replaces 1266 03 00 6) Replaces 1266 21 00

CONTROLLER
Series CRC



CRC
Weather compensation controller, 230 V AC



Art. No.	Reference	Torque [Nm]	Note	Euro/pcs
12820100	CRC111	6		318,00
12820300	CRC113		3)	369,00
12820500	CRC115		4)	318,00

CONTROLLER
Series CUA



CUA
Dual function controller, capable of both constant flow temperature control and indoor sensor based regulation. 230 V AC



Art. No.	Reference	Room display unit	Note	Euro/pcs
12640100	CUA111	Cable		323,00
12642200	CUA122	Wireless		467,00

ESBE ACCESSORIES
GSM MODULE



CRB915
GSM-module to be connected to ESBE controllers series CRB100, CRA110, CRA120 and CUA110.



Art. No.	Reference	Voltage [VAC]	Note	Euro/pcs
17055900	CRB915	230		343,00

SENSORS, ADAPTOR KITS



Options CRA, CRB, CRC, CUA

Art. No.	Reference	Designation	Euro/pcs
17053100	CRA911	Flow pipe sensor, 5m cable	26,00
17056000	CRC911	Outdoor sensor [CRC]	50,00
17051300	CRB916	Temperature sensor [CRB915]	50,00
		Different adaptor kits suitable – see pages 12-13.	

ESBE SYSTEM COMPONENTS
CONTROLLER UNITS



VRB141 + CRA111
Bivalent valve PN10 + Controller, 230 V AC



Art. No.	Mixing valve			Controller	Euro/pcs
	DN	Kvs	Connection		
13040100	25	10	Rp 1"	CRA111	395,00



VRG131 + CRC111
Mixing valve PN10 + Controller, 230 V AC



Art. No.	Mixing valve			Controller	Euro/pcs
	DN	Kvs	Connection		
13041000	20	6,3	Rp 3/4"	CRC111	354,00
13041100	25	10	Rp 1"		358,00

Notes: 1) Replaces 12600100 (95C) 2) Without internal timer 3) With pump control wire box 4) With UK socket 5) Replaces 1266 03 00 6) Replaces 1266 21 00

ADAPTOR KITS

Guide for use to ESBE actuators and controllers

● Comes with the actuator ● Order separately



Type	Reference	Art. No.		Euro/ pcs	Series ARA, CRA110, CRB, CRC	Series CRA120, 90	Series 90C
ARA803	ESBE VRG, VRB + ESBE MG, G, F, BIV, H, HG	16000500		8,00	●		
VRG801	ESBE VRG, VRB	16053300		15,00		●	
VRG804	ESBE VRG, VRB without hand lever for controller 90C	16053700		15,00			●
ARA802	ESBE Series MG, G, F, BIV, H, HG	16000400		6,00	●		
900	ESBE Series MG, G, F, BIV, H, HG	16051300		11,00		●	
90C	ESBE Serie MG, G without hand lever for controller 90C	16053200		11,00			●
900-270	ESBE Serie MG, G without hand lever for actuator 92P4, 95-270M	16053400		11,00		●	
ARA806	Honeywell Centra Corona, Series V5433A, V5433G, V5442A, V5442G	16000800		20,00	●		
ARA808	Lovato	16000900		10,00	●		
ARA805	Meibes	16000600		6,00	●		
ARA809	PAW	16001000		25,00	●		



Type	Reference	Art. No.		Euro/ pcs	Series ARA, CRA110, CRB, CRC	Series CRA120, 90	Series 90C
ARA807	Watts	16000700		6,00	●		
900C	Honeywell Centra ZR, DR, DRU, DRG (DN15 - DN50)	16053900		38,00		●	● *
900CK	Honeywell Centra Kompakt DRK/ZRK	16051700		38,00		●	● *
900F	Meibes / Oventrop/ Watts/ BRV	16053600		34,00		●	● *
900K	Siemens VBG31, VBI31, VBF21, VCI31	16052500		49,00		●	● *
900D	Wita	16051800		49,00		●	● *
900A	TA-VTR	16051400		49,00		●	● *
900L	Schneider Electric TRV / TAC-TRV	16052600		49,00		●	● *
900B	Viessmann (DN20 - DN25)	16051500		49,00		●	● *
90C-BRV	BRV	16053500		15,00		●	● *
900E	CTC (linear movement)	16051900		113,00		●	

* The adapter kit comes with a hand lever and for the controller series 90C this must be removed. It is not required for assembly.

ROTARY UNITS

Guide for use to ESBE actuators and controllers

● Recommended ● Secondary alternative

	Actuators						Controllers				
	ARA600		90			90C	CRC100	CRB100	CRA110	CRA120	
	3-P	2-P	Prop.	3-P	2-P	Prop.					
 VRG130	●	●	●	●*	●*	●*	●	●	●	●	●*
 3F	●	●	●	●	●	●	●	●	●	●	●
 VRG140	●	●	●	●*	●*	●*	●	●	●	●	●*
 4F	●	●	●	●	●	●	●	●	●	●	●
 VRG230	●	●	●	●*	●*	●*	●	●	●	●	●*
 VRG330	●	●	●	●*	●*	●*	●	●	●	●	●*
 VRB140	●	●	●	●*	●*	●*	●	●	●	●	●*
 5MG				●**		●**					
 VRH130	●	●	●	●*	●*	●*	●	●	●	●	●*

Notes: *Additional adaptor kit necessary, see pages 12-13 ** Only type 95-270M and 92P4

SOLID FUEL PRODUCTS



LOAD UNITS Series LTC200



LTC261 Internal thread, PN6

Art. No.	DN	Connection Adapter	Power		Temp.*	Euro/pcs
			[kW]	(max. Δt)		
55004000	25	Rp 1"	90	35	55°C	581,00
55004100			75	30	60°C	581,00
55004200			65	25	65°C	581,00
55004300			50	20	70°C	581,00
55004400	32	Rp 1 1/4"	100	35	55°C	592,00
55004500			85	30	60°C	592,00
55004600			70	25	65°C	592,00
55004700	40	Rp 1 1/2"	55	20	70°C	592,00
55004800			105	35	55°C	602,00
55004900			90	30	60°C	602,00
55005000			75	25	65°C	602,00
55005100			60	20	70°C	602,00

LOAD UNITS Series LTC100



LTC141 Internal thread, PN6

Art. No.	DN	Connection Adapter	Power		Temp.*	Euro/pcs
			[kW]	(max. Δt)		
55000100	25	Rp 1"	85	40	50°C	492,00
55000200			75	35	55°C	492,00
55000300			65	30	60°C	492,00
55001100			55	25	65°C	492,00
55000400			45	20	70°C	492,00
55000500			35	15	75°C	492,00
55000600	32	Rp 1 1/4"	85	40	50°C	492,00
55000700			75	35	55°C	492,00
55000800			65	30	60°C	492,00
55001200			55	25	65°C	492,00
55000900			45	20	70°C	492,00

LTC143 Compression fitting, PN6

Art. No.	DN	Connection Adapter	Power		Temp.*	Euro/pcs
			[kW]	(max. Δt)		
55001400	25	CPF 28 mm	75	35	55°C	499,00
55001500			65	30	60°C	499,00
55002300			55	25	65°C	499,00

Further technical information

On our website you will find loads of useful information like instruction manuals, certificates and technical data. You also might discover some additional article numbers.

Scan the QR-code and go to address <http://www.esbe.eu/gb/en/products>



LTC171

Internal thread, PN6

Art. No.	DN	Connection Adapter	Power		Temp.*	Euro/pcs
			[kW]	(max. Δt)		
55002600	40	Rp 1 1/2"	105	35	55°C	543,00
55002700			90	30	60°C	543,00
55003500			75	25	65°C	543,00
55002800			60	20	70°C	543,00
55003100	50	Rp 2"	120	35	55°C	561,00
55003200			100	30	60°C	561,00
55003600			80	25	65°C	561,00
55003300			65	20	70°C	561,00

LOAD VALVE Series VTC530



VTC531 Internal thread, PN6

Art. No.	DN	Kvs	Connection	Temp.*	Euro/pcs
51025600	55°C	234,00			
51025700	60°C	234,00			
51027500	65°C	234,00			
51025800	70°C	234,00			
51026000	32	8	Rp 1 1/4"	50°C	236,00
51026100				55°C	236,00
51026200				60°C	236,00
51027600				65°C	236,00
51026300				70°C	236,00
51026500	40	8	Rp 1 1/2"	50°C	239,00
51026600				55°C	239,00
51026700				60°C	239,00
51027700				65°C	239,00
51026800				70°C	239,00
51027000	50	12	Rp 2"	50°C	253,00
51027100				55°C	253,00
51027200				60°C	253,00
51027800				65°C	253,00
51027300				70°C	253,00

Notes: *Mixed temperature.

LOAD VALVE
Series VTC510



VTC511 Internal thread, PN10

Art. No.	DN	Kvs	Connection	Temp.*	Euro/pcs
51020100	25	9	Rp 1"	50°C	97,00
51020200				55°C	97,00
51020300				60°C	97,00
51021100				65°C	97,00
51020400				70°C	97,00
51020500				75°C	97,00
51020600	32	14	Rp 1 1/4"	50°C	100,00
51020700				55°C	100,00
51020800				60°C	100,00
51021200				65°C	100,00
51020900				70°C	100,00
51021000				75°C	100,00



VTC512 External thread, PN10

Art. No.	DN	Kvs	Connection	Temp.*	Euro/pcs
51021500	25	9	G 1 1/4"	50°C	97,00
51021600				55°C	97,00
51021700				60°C	97,00
51022500				65°C	97,00
51021800				70°C	97,00
51022000				75°C	97,00
51022100	32	14	G 1 1/2"	50°C	100,00
51022200				55°C	100,00
51022600				60°C	100,00
51022300				65°C	100,00

LOAD VALVE
Series VTC300



VTC311 Internal thread, PN10

Art. No.	DN	Kvs	Connection	Temp.*	Euro/pcs
51000100	20	3.2	Rp 3/4"	45°C	80,00
51000200				55°C	80,00
51000300				60°C	80,00
51000400				70°C	80,00



VTC317 Pumpflange/External thread, PN10

Art. No.	DN	Kvs	Connection	Temp.*	Euro/pcs
51002200	20	3.2	PF 1 1/2", G 1"	45°C	97,00
51002300				55°C	97,00
51002400				60°C	97,00
51002500				70°C	97,00

LOAD VALVE
Series VTC300



VTC312 External thread, PN10

Art. No.	DN	Kvs	Connection	Temp.*	Euro/pcs
51000800	15	2.8	G 3/4"	45°C	80,00
51000900				55°C	80,00
51001000				60°C	80,00
51001100				70°C	80,00
51001500	20	3.2	G 1"	45°C	80,00
51001600				55°C	80,00
51001700				60°C	80,00
51001800				70°C	80,00



VTC318 Rotating nut/External thread, PN10

Art. No.	DN	Kvs	Connection	Temp.*	Euro/pcs
51002900	20	3.2	RN 1", G 1"	45°C	95,00
51003000				55°C	95,00
51003100				60°C	95,00
51003200				70°C	95,00

LOAD VALVE SET
Series UTC317



UTC317 Pumpflange + External thread, PN10

Consists of:
Load valve VTC317, with opening temperatur: _____ 60 °C
and
Premix valve VTC318, with opening temperatur: _____ 45 °C

Art. No.	DN	Kvs	Connection	Temp.*	Euro/pcs
51500100	20	2.3	RN 1", G 1"	60°C + 45°C	182,00

DRAUGHT REGULATOR
Series ATA200



Art. No.	Reference	Temp. range	Connection	Note	Euro/pcs
56001100	ATA212	35-95°	G 3/4"	1), 3)	37,00
56001500			G 1"	2), 3)	42,00
56001200	ATA222	60-95°	G 1"	1), 4)	37,00
56001300			G 3/4"	1)	38,00

Notes: *Mixed temperature.

FLUE GAS THERMOSTAT Series CTF150



CTF151

Art. No.	Switch temp. range	Max. temp. probe	Note	Euro/pcs
56020100	20-240°C	500°C		100,00

Options series CTF151

Art. No.	Reference	Designation	Euro/pcs
56020200	CTF851	Immersion pocket	32,00

THERMAL SAFETY VALVE Series VST100



VST112 Internal thread, PN10

Art. No.	Opening temp.	Relief capacity	Connection		Euro/pcs
36027000	95°C ⁺⁰ / ₋₄	2.1 [m3/h] ¹⁾	G 3/4"	G 1/2"	102,00

¹⁾At 1 Bars pressure differential

ESBE ACCESSORIES

THERMOSTATS ETC.



Options series LTC100, LTC200, VTC530, VTC510

Art. No.	Reference	Designation	Euro/pcs
57020100	VTC951	Thermostat 50°C	21,00
57020200		Thermostat 55°C	21,00
57020300		Thermostat 60°C	21,00
57020800		Thermostat 65°C	21,00
57020400		Thermostat 70°C	21,00
57020500		Thermostat 75°C	21,00
57020600	VTC952	Thermometer, 3pcs	43,00
57020700	VTC953	Insulation, ≥ DN32	29,00

Options series VTC300

Art. No.	Reference	Designation	Euro/pcs
57000100	VTC931	Thermostat 45°C	17,00
57000200		Thermostat 55°C	17,00
57000300		Thermostat 60°C	17,00
57000400		Thermostat 70°C	17,00
57000500		Thermostat 80°C	17,00

ALL THE SUPPORT TOOLS YOU NEED

To make your workday as smooth as possible.

APP FOR ON-SITE ASSISTANCE

Try our App for installation assistance! It's a modern, highly portable tool for doing correct valve dimensioning anywhere.

> Scan and download with your iPhone or Android.



CLASSIC SELECTION TOOL

Also free, but much less digital, is the ESBE Valve Dimensioning tool, a slide chart that no installer should be without.

> Ask your local ESBE contact or order at esbe.eu



EXTENSIVE ONLINE WEB SUPPORT

Technical data, instruction manuals and certificates are always available on our website. You can also download and install our popular "ESBE Hydronic selection" software.

> Visit esbe.eu for more info



PRINTED TECHNICAL DOCUMENTATION

ESBE offer printed material ranging from installation instruction manuals and installation specific guides to our full-blown catalogue, complete with technical specifications and installation examples.

> Order catalogue or read online at esbe.eu



Solid fuel products – Notes: 1) Immersion pocket 50mm 2) Immersion pocket 75mm 3) Replaces 31800200 4) Replaces 31800300

ESBE SYSTEM COMPONENTS

DIVERTING VALVES



Further technical information

On our website you will find loads of useful information like instruction manuals, certificates and technical data. You also might discover some additional article numbers.

Scan the QR-code and go to address <http://www.esbe.eu/gb/en/products>



MOTORIZED DIVERTING VALVE

Series VZC

VZC161

Internal thread, PN6, IP20

Art. No.	DN	Kvs*	Connection	Note	Euro/pcs
43060200	20	6.0	Rp 3/4"	1)	118,00



VZC162

External thread, PN6, IP20

Art. No.	DN	Kvs*	Connection	Note	Euro/pcs
43060600	15	3.5	G 3/4"	1)	118,00
43060700	20	6.0	G 1"	2)	106,00
43060800			G 1"	1)	118,00



VZC152

External thread, PN6, IP20

Art. No.	DN	Kvs*	Connection	Note	Euro/pcs
43061200	20	6.0	G 1"	1), 4)	137,00

VZC263

Compression fitting, PN6, IP20

Art. No.	DN	Kvs*	Connection	Note	Euro/pcs
43061400	20	4.5	CPF 22 mm	1)	126,00
43061600	25	6.0	CPF 28 mm	1)	138,00



MOTORIZED DIVERTING VALVE

Series VZD

VZD161

Internal thread, PN6, IP40

Art. No.	DN	Kvs*	Connection	Note	Euro/pcs
43080100	20	6.0	Rp 3/4"	3)	118,00



VZD162

External thread, PN6, IP40

Art. No.	DN	Kvs*	Connection	Note	Euro/pcs
43080300	15	3.5	G 3/4"	3)	118,00
43080400	20	6.0	G 1"		118,00



VZD263

Compression fitting, PN6, IP40

Art. No.	DN	Kvs*	Connection	Note	Euro/pcs
43080700	20	4.5	CPF 22 mm	3)	126,00
43080800	25	6.0	CPF 28 mm		138,00



ESBE ACCESSORIES

CABLES

Options series VZC, VZD

Art. No.	Reference	Designation**	Euro/pcs
46050100	ALZ801	Cable, fixed version IP40, 3-wire	17,00
46050200		Cable, fixed version IP40, 6-wire for use with auxiliary switch	27,00
46050300		Cable, loose version IP20, 3-wire	17,00
46050400		Cable, loose version IP20, 6-wire for use with auxiliary switch	27,00



THERMOSTATIC DIVERTING VALVE

Series VTD300

VTD322

External thread, PN10

Art. No.	DN	Kvs	Connection	Change-over point	Euro/pcs
31600100	20	3.6	G 1"	45°C	80,00
31600200				50°C	80,00
31600300				60°C	80,00
31600400				70°C	80,00

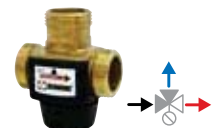

Series VTD500

VTD582

External thread, PN10

Art. No.	DN	Kvs	Connection	Change-over point	Euro/pcs
31580100	20	2.8	G 1"	40-52°C	106,00



Diverting valves - Notes: *Kvs-value in diverting mode measured as m³/h at a pressure drop of 1 bar; Kvs-value in mixing mode 10% lower. **Compatible with article numbers 4306xxxx and 4308xxxx (not 4300xxxx)

1) Detachable cable 2) Without cable 3) Fixed cable 4) With auxiliary switch

THERMOSTATIC UNITS



CIRCULATION SET Series VTR300



VTR322 External thread, PN10

Art. No.	Temp. range	Kvs	Connection	Euro/pcs
31400100	35-60°C	1.6	R 3/4"	187,00

VALVE MANIFOLD Series VMB400



VMB423 Compression fitting, PN10

Art. No.	DN	Kvs	Connection	Safety valve		Euro/pcs
				[MPa]	[bar]	
31502000	15	1.1	CPF 15 mm	—	—	85,00
31502600				1.0	10	102,00
31502100	20	1.6	CPF 22 mm	—	—	88,00
31502200				0.6	6	102,00
31502300				0.7	7	102,00
31502400				0.9	9	102,00
31502500				1.0	10	102,00

SOLAR KIT



Series VMD300



VMD322 External thread, PN10

Art. No.	Change-over point	Kvs	Connection	Euro/pcs
31525000	40-52°C	1.4	R 3/4"	281,00

Series VMC300



VMC322 External thread, PN10

Art. No.	Change-over point	Kvs	Connection *	Euro/pcs
31521000	45°C	1.5	G 1"	181,00
31521100	50°C			181,00
31521200	60°C			181,00

VMC322 External thread with adapters, PN10

Art. No.	Change-over point	Kvs	Connection	Note	Euro/pcs
31521300	45°C	1.4	G 1"	1) R 3/4"	222,00
31521400	50°C				222,00
31521500	60°C				222,00

Series VMC500



VMC522 External thread, PN10

Art. No.	Change-over point	Kvs	Connection	Euro/pcs
31523000	45°C	2.5	G 1"	214,00
31523100	50°C			214,00
31523200	60°C			214,00

VMC522 External thread with adapters, PN10

Art. No.	Change-over point	Kvs	Connection	Note	Euro/pcs
31523300	45°C	2.3	G 1"	1) R 3/4"	255,00
31523400	50°C				255,00
31523500	60°C				255,00

Notes: * The matching connection kit for your valve can be found on page 23. 1) Two check valves for both hot and cold water are included

ESBE SYSTEM COMPONENTS
THERMOSTATIC MIXING VALVES



THERMOSTATIC MIXING VALVE
 Basic series VTA320, VTA520



VTA321
 Internal thread, PN10

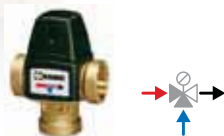

Art. No.	Temp. range	Kvs	Connection	Note	Euro/pcs
31100300	20 - 43°C	1.5	Rp 1/2"		68,00
31100700		1.6	Rp 3/4"		72,00
31100400	35 - 60°C	1.5	Rp 1/2"		62,00
31100800		1.6	Rp 3/4"		68,00

VTA322, VTA522
 External thread, PN10

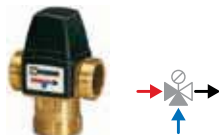

Art. No.	Ref.	Temp. range	Kvs	Connection*	Euro/pcs
31102800	VTA322	20 - 43°C	1.2	G 1/2"	61,00
31100500			1.5	G 3/4"	68,00
31100900			1.6	G 1"	72,00
31620100	VTA522	20 - 43°C	3.2	G 1"	100,00
31620400			3.5	G 1 1/4"	103,00
31102900	VTA322	35 - 60°C	1.2	G 1/2"	57,00
31100600			1.5	G 3/4"	63,00
31101000			1.6	G 1"	68,00
31104700	VTA322	45 - 65°C	1.6	G 1"	63,00
31620200	VTA522		3.2	G 1"	100,00
31620500			3.5	G 1 1/4"	103,00
31103200	VTA322	30 - 70°C	1.6	G 1"	68,00
31620300	VTA522	50 - 75°C	3.2	G 1"	100,00
31620600			3.5	G 1 1/4"	103,00

Further technical information

On our website you will find loads of useful information like instruction manuals, certificates and technical data. You also might discover some additional article numbers.

Scan the QR-code and go to address <http://www.esbe.eu/gb/en/products>



VTA323
 Compression fitting, PN10



Art. No.	Temp. range	Kvs	Connection	Note	Euro/pcs
31102600	20 - 43°C	1.2	CPF 15 mm	2)	73,00
31100100		1.5	CPF 22 mm		73,00
31102700	35 - 60°C	1.2	CPF 15 mm	2)	71,00
31103900		1.5	CPF 18 mm		79,00
31100200		1.5	CPF 22 mm	2)	71,00

VTA522
 External thread with adapters, PN10



Art. No.	Temp. range	Kvs	Connection	Note	Euro/pcs
31620700	20 - 43°C	3.0	G 1"	R 3/4"	120,00
31621000		3.4		R 1"	137,00
31620800	45 - 65°C	3.0	G 1"	R 3/4"	120,00
31621100		3.4		R 1"	137,00
31620900	50 - 75°C	3.0	G 1"	R 3/4"	120,00
31621200		3.4		R 1"	137,00

VTA523
 Compression fitting with adapters, PN10



Art. No.	Temp. range	Kvs	Connection	Note	Euro/pcs
31621300	20 - 43°C	3.0	G 1"	1)	125,00
31621600		3.4			CPF 28mm
31621400	45 - 65°C	3.0	G 1"	1)	125,00
31621700		3.4			CPF 28mm
31621500	50 - 75°C	3.0	G 1"	1)	125,00
31621800		3.4			CPF 28mm

THERMOSTATIC MIXING VALVE
 Basic series VTA350, VTA550



VTA351
 Internal thread, PN10



Art. No.	Temp. range	Kvs	Connection	Note	Euro/pcs
31104900	35 - 60°C	1.6	Rp 3/4"		68,00

VTA352, VTA552
 External thread, PN10

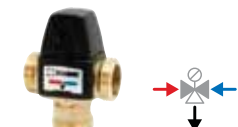

Art. No.	Ref.	Temp. range	Kvs	Connection*	Euro/pcs
31660100	VTA552	20 - 43°C	3.2	G 1"	100,00
31660400			3.5	G 1 1/4"	103,00
31105000	VTA352	35 - 60°C	1.5	G 3/4"	63,00
31105100			1.6	G 1"	68,00
31660200	VTA552	45 - 65°C	3.2	G 1"	100,00
31660500			3.5	G 1 1/4"	103,00
31660300	VTA552	50 - 75°C	3.2	G 1"	100,00
31660600			3.5	G 1 1/4"	103,00

Notes: * The matching connection kit for your valve can be found on page 23. 1) Two check valves for both hot and cold water are included 2) A non-return valve for the cold water is included.

VTA353

Compression fitting, PN10

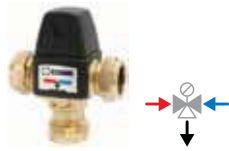

Art. No.	Temp. range	Kvs	Connection	Note	Euro/pcs
31105200	35 - 60°C	1.5	CPF 22 mm		71,00

**VTA552**

External thread with adapters, PN10

Art. No.	Temp. range	Kvs	Connection	Note	Euro/pcs	
31660700	20 - 43°C	3.0	G 1"	1)	120,00	
31661000		3.4			R 1"	137,00
31660800	45 - 65°C	3.0	G 1"		R ¾"	120,00
31661100		3.4			R 1"	137,00
31660900	50 - 75°C	3.0	G 1"		R ¾"	120,00
31661200		3.4			R 1"	137,00

VTA553

Compression fitting with adapters, PN10

Art. No.	Temp. range	Kvs	Connection	Note	Euro/pcs
31661300	20 - 43°C	3.0	G 1"	1)	125,00
31661400	45 - 65°C				125,00
31661500	50 - 75°C				125,00

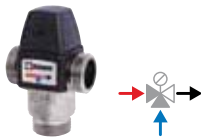
THERMOSTATIC MIXING VALVE
Premium series VTA330, VTA530**VTA332, VTA532**

External thread, PN10

Art. No.	Ref.	Temp. range	Kvs	Connection*	Note	Euro/pcs
31150200	VTA332	32 - 49°C	1.2	G ¾"	4)	101,00
31641000	VTA532		2.3	G 1"		115,00
31641100		2.5	G 1¼"	121,00		
31150700	VTA332	35 - 60°C	1.2	G ¾"		103,00
31150900			1.3	G 1"	99,00	
31640100	VTA532	45 - 65°C	2.3	G 1"	3)	115,00
31640200			2.5	G 1¼"		121,00

VTA333

Compression fitting, PN10



Art. No.	Temp. range	Kvs	Connection	Note	Euro/pcs
31150300	35 - 60°C	1.2	CPF 22 mm	2)	121,00
31152100			CPF 15/22 mm		120,00

**VTA532**

External thread with adapters, PN10

Art. No.	Temp. range	Kvs	Connection	Note	Euro/pcs
31641200	35 - 50°C	2.2	G 1"	1), 4)	143,00
31641300		2.5			R 1"
31640300	45 - 65°C	2.2	G 1"	1), 3)	143,00
31640400		2.5			R 1"

VTA533

Compression fitting with adapters, PN10

Art. No.	Temp. range	Kvs	Connection	Note	Euro/pcs
31641400	35 - 50°C	2.2	G 1"	1), 4)	144,00
31641500		2.5			CPF 28mm
31640500	45 - 65°C	2.2	G 1"	1), 3)	144,00
31640600		2.5			CPF 28mm

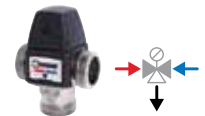
THERMOSTATIC MIXING VALVE
Premium series VTA360, VTA560**VTA362, VTA562**

External thread, PN10

Art. No.	Ref.	Temp. range	Kvs	Connection*	Note	Euro/pcs
31151400	VTA362	32 - 49°C	1.2	G ¾"	4)	85,00
31681000	VTA562		2.3	G 1"		115,00
31681100		2.5	G 1¼"	121,00		
31151100	VTA362	35 - 60°C	1.2	G ¾"		85,00
31151200			1.3	G 1"	85,00	
31680100	VTA562	45 - 65°C	2.3	G 1"	3)	115,00
31680200			2.5	G 1¼"		121,00

VTA363

Compression fitting, PN10



Art. No.	Temp. range	Kvs	Connection	Note	Euro/pcs
31151000	35 - 60°C	1.2	CPF 22 mm	2)	104,00

**VTA562**

External thread with adapters, PN10

Art. No.	Temp. range	Kvs	Connection	Note	Euro/pcs
31681200	35 - 50°C	2.2	G 1"	1), 4)	143,00
31681300		2.5			R 1"
31680300	45 - 65°C	2.2	G 1"	1), 3)	143,00
31680400		2.5			R 1"

VTA563

Compression fitting with adapters, PN10

Art. No.	Temp. range	Kvs	Connection	Note	Euro/pcs
31681400	35 - 50°C	2.2	G 1"	1), 4)	144,00
31681500		2.5			CPF 28mm
31680500	45 - 65°C	2.2	G 1"	1), 3)	144,00
31680600		2.5			CPF 28mm

Notes: * The matching connection kit for your valve can be found on page 23. 1) Two check valves for both hot and cold water are included 2) A non-return valve for the cold water is included. 3) According to standard EN 15092 4) According to standard EN 1111 + NF079 (France)

ESBE SYSTEM COMPONENTS
THERMOSTATIC MIXING VALVES

THERMOSTATIC MIXING VALVE
 Solar series VTS520



VTS522
 External thread, PN10

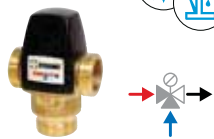

Art. No.	Temp. range	Kvs	Connection*	Note	Euro/pcs
31720100	45 - 65°C	3.2	G 1"		119,00
31720300		3.5	G 1¼"		123,00
31720200	50 - 75°C	3.2	G 1"		119,00
31720400		3.5	G 1¼"		123,00



VTS522
 External thread with adapters, PN10

Art. No.	Temp. range	Kvs	Connection	Note	Euro/pcs
31720500	45 - 65°C	3.0	G 1"	1)	138,00
31720700		3.4			R 1"
31720600	50 - 75°C	3.0	R ¾"		138,00
31720800		3.4	R 1"		156,00

VTS523 Compression fitting with adapters, PN10

Art. No.	Temp. range	Kvs	Connection	Note	Euro/pcs
31720900	45 - 65°C	3.0	G 1"	1)	143,00
31721100		3.4			CPF 28mm
31721000	50 - 75°C	3.0	CPF 22mm		143,00
31721200		3.4	CPF 28mm		154,00

THERMOSTATIC MIXING VALVE
 Solar series VTS550



VTS552
 External thread, PN10



Art. No.	Temp. range	Kvs	Connection*	Note	Euro/pcs
31740100	45 - 65°C	3.2	G 1"		119,00
31740300		3.5	G 1¼"		123,00
31740200	50 - 75°C	3.2	G 1"		119,00
31740400		3.5	G 1¼"		123,00



VTS552
 External thread with adapters, PN10

Art. No.	Temp. range	Kvs	Connection	Note	Euro/pcs
31740500	45 - 65°C	3.0	G 1"		134,00
31740700		3.4			R 1"
31740600	50 - 75°C	3.0	R ¾"		134,00
31740800		3.4	R 1"		151,00

VTS553 Compression fitting with adapters, PN10

Art. No.	Temp. range	Kvs	Connection	Note	Euro/pcs
31740900	45 - 65°C	3.0	G 1"		143,00
31741000	50 - 75°C				CPF 22mm

THERMOSTATIC MIXING VALVE



Basic series
 VTA370, VTA570



VTA372, VTA572
 External thread, PN10

Art. No.	Ref.	Temp. range	Kvs	Connection*	Euro/pcs
31700100	VTA572	10 - 30°C	4.5	G 1"	104,00
31700400			4.8	G 1¼"	110,00
31105300	VTA372	20 - 43°C	2.3	G 1"	86,00
31700200	VTA572	20 - 43°C	4.5	G 1"	104,00
31700500			4.8	G 1¼"	110,00
31105400	VTA372	35 - 60°C	2.3	G 1"	86,00
31700300	VTA572	45 - 65°C	4.5	G 1"	104,00
31700600			4.8	G 1¼"	110,00

VTA377, VTA577
 Pump flange and External thread, PN10



Art. No.	Ref.	Temp. range	Kvs	Connection	Euro/pcs
31105500	VTA377	20 - 43°C	2.3	G 1" PF1½"	104,00
31701100	VTA577		4.5		128,00
31105600	VTA377	35 - 60°C	2.3		104,00
31701200	VTA577	45 - 65°C	4.5		128,00

VTA378, VTA578
 Rotating nut and External thread, PN10



Art. No.	Ref.	Temp. range	Kvs	Connection	Euro/pcs
31105700	VTA378	20 - 43°C	2.3	G 1" RN 1"	100,00
31701700	VTA578		4.5		126,00
31105800	VTA378	35 - 60°C	2.3		100,00
31701800	VTA578	45 - 65°C	4.5		126,00

THERMOSTATIC MIXING VALVE
 Series VTA310



VTA312
 External thread, PN10



Art. No.	Temp. range	Kvs	Connection	Note	Euro/pcs
31050200	35 - 60°C	1.2	G ½"		43,00

VTA313
 Compression fitting, PN10



Art. No.	Temp. range	Kvs	Connection	Note	Euro/pcs
31050100	35 - 60°C	1.2	CPF 15 mm	2)	54,00
31050400		1.5	CPF 22 mm		61,00
31050500	30 - 70°C	1.5	CPF 22 mm		59,00

Further technical information

On our website you will find loads of useful information like instruction manuals, certificates and technical data. You also might discover some additional article numbers.

Scan the QR-code and go to address <http://www.esbe.eu/gb/en/products>



Notes: * The matching connection kit for your valve can be found on page 23. 1) Two check valves for both hot and cold water are included 2) A non-return valve for the cold water is included. 3) According to standard EN 15092 4) According to standard EN 1111 + NF079 (France)

ESBE ACCESSORIES

CONNECTION KIT
Series KCD300



KCD313

Compression fitting, PN10

Art. No.	Valve thread	Connection	Note	Euro/pcs
36552800	G 3/4"	CPF 15 mm	1)	22,00
36553100			1), Plated	24,00
36552900	G 1"	CPF 22 mm	1)	29,00
36553200			1), Plated	33,00
36554100			3)	20,00
36553000	G 1 1/4"	CPF 28 mm	1)	36,00
36553300			1), Plated	42,00

CONNECTION KIT
Series KSD300



KSD314

Fittings soldering type, PN10

Art. No.	Valve thread	Connection	Note	Euro/pcs
36553400	G 1"	22 mm	1)	28,00

CONNECTION KIT
Series KTD200, KTD300



KTD212, KTD312

External thread, PN10

Art. No.	Ref.	Valve thread	Connection thread	Note	Euro/pcs
36552200	KTD212	G 1"	R 3/4"	2)	20,00
36552400	KTD312			1)	24,00
36552600				1), Plated	32,00
36552300	KTD212	G 1 1/4"	R 1"	2)	33,00
36552500	KTD312			1)	38,00
36552700				1), Plated	40,00

ESBE SYSTEM COMPONENTS

LINEAR MOTORIZED VALVES



CONTROL VALVE
Series VLF100, VLF300



VLF125
2-Way Control Valve PN6

Art. No.	Reference	DN	Kvs	Note	Euro/pcs
21000100	VLF125	15	1.6	1), 2)	176,00
21000200			2.5		176,00
21000300			4		177,00
21000400		20	6.3		187,00
21000500		25	10		193,00
21000600		32	16		237,00
21000700		40	25		249,00
21000800		50	38		302,00

VLF135, VLF335
3-Way Control Valve PN6



Art. No.	Reference	DN	Kvs	Note	Euro/pcs
21000900	VLF135	15	1.6	1), 2)	180,00
21001000			2.5		186,00
21001100			4		187,00
21001200		20	6.3		212,00
21001300		25	10		213,00
21001400		32	16		266,00
21001500	VLF335	40	25	1)	335,00
21001600			38		396,00
21001900		65	49		484,00
21002000		80	78		762,00

Connection kit - Notes: 1) 3 connections/package, Two check valves included 2) 3 connections/package, One check valve included 3) 2 connections/package, One check valve included

Control valve - Notes: 1) Stroke 20 mm 2) With premounted flange gasket

LINEAR MOTORIZED VALVES

CONTROL VALVE

Series VLA100, VLA200



VLA121
2-Way Control Valve PN16

Art. No.	DN	Kvs	Connection	Note	Euro/pcs
21150100	15	1.6	Rp 1/2"	1)	94,00
21150200		2.5			94,00
21150300		4			94,00
21150400	20	6.3	Rp 3/4"		104,00
21150500	25	10	Rp 1"		116,00
21150600	32	16	Rp 1 1/4"		134,00
21150700	40	25	Rp 1 1/2"		149,00
21150800	50	38	Rp 2"		205,00



VLA221
2-Way Control Valve PN16
With pressure balanced plug

Art. No.	DN	Kvs	Connection	Note	Euro/pcs
21151700	25	10	Rp 1"	1)	159,00
21151800	32	16	Rp 1 1/4"		175,00
21151900	40	25	Rp 1 1/2"		228,00
21152000	50	38	Rp 2"		283,00



VLA131
3-Way Control Valve PN16

Art. No.	DN	Kvs	Connection	Note	Euro/pcs
21150900	15	1.6	Rp 1/2"	1)	105,00
21151000		2.5			105,00
21151100		4			105,00
21151200	20	6.3	Rp 3/4"		112,00
21151300	25	10	Rp 1"		127,00
21151400	32	16	Rp 1 1/4"		142,00
21151500	40	25	Rp 1 1/2"		168,00
21151600	50	38	Rp 2"		229,00

CONTROL VALVE

Series VLA300, VLA400, VLB200



VLA325
2-Way Control Valve PN16

Art. No.	Reference	DN	Kvs	Note	Euro/pcs
21200100	VLA325	15	1.6	1), 2)	159,00
21200200			2.5		159,00
21200300			4		159,00
21200400		20	6.3		172,00
21200500		25	10		189,00
21200600		32	16		233,00
21200700		40	25		249,00
21200800		50	38		302,00



VLB225
2-Way Control Valve PN16

Art. No.	Reference	DN	Kvs	Note	Euro/pcs
21203100	VLB225	65	49	1)	764,00
21203200		80	78		1.029,00
21203300		100	124	3)	1.535,00
21203400		125	200		2.006,00
21203500		150	300		2.493,00



VLA425
2-Way Control Valve PN16
With pressure balanced plug

Art. No.	Reference	DN	Kvs	Note	Euro/pcs
21201700	VLA425	25	10	1), 2)	236,00
21201800		32	16		277,00
21201900		40	25		311,00
21202000		50	38		396,00



VLA335, VLA235
3-Way Control Valve PN16

Art. No.	Reference	DN	Kvs	Note	Euro/pcs	
21200900	VLA335	15	1.6	1), 2)	175,00	
21201000			2.5		175,00	
21201100			4		175,00	
21201200		20	6.3		200,00	
21201300		25	10		213,00	
21201400		32	16		257,00	
21201500		40	25		321,00	
21201600		50	38		382,00	
21203600		VLB235	65	49	1)	693,00
21203700			80	78		915,00
21203800			100	124	3)	1.393,00
21203900			125	200		2.346,00
21204000	150		300	2.787,00		

CONTROL VALVE

Series VLE100



VLE122
2-Way Control Valve PN16

Art. No.	DN	Kvs	Connection*	Note	Euro/pcs	
21250100	15	0.25	G 1"	1)	165,00	
21250200		0.4			165,00	
21250300		0.63			165,00	
21250400		1			165,00	
21250500		1.6			165,00	
21250600		2.5			165,00	
21250700		4			165,00	
21250800		20			6.3	G 1 1/4"
21250900		25	10		G 1 1/2"	214,00
21251000		32	16		G 2"	246,00
21251100		40	25		G 2 1/4"	311,00
21251200		50	38		G 2 3/4"	368,00

Notes: 1) Stroke 20 mm 2) With premounted flange gasket 3) Stroke 40 mm * The matching connection kit for your valve can be found on page 27.

VLE2222-Way Control Valve PN16
With pressure balanced plug

Art. No.	DN	Kvs	Connection*	Note	Euro/pcs
21252100	25	10	G 1½"	1)	288,00
21252200	32	16	G 2"		375,00
21252300	40	25	G 2¼"		449,00
21252400	50	38	G 2¾"		563,00

VLE132

3-Way Control Valve PN16



Art. No.	DN	Kvs	Connection*	Note	Euro/pcs
21251300	15	1.6	G 1"	1)	165,00
21251400		2.5			165,00
21251500		4			165,00
21251600	20	6.3	G 1¼"		185,00
21251700	25	10	G 1½"	215,00	
21251800	32	16	G 2"	246,00	
21251900	40	25	G 2¼"	311,00	
21252000	50	38	G 2¾"	383,00	

CONTROL VALVESeries VLC100, VLC200,
VLC300, VLC400**VLC125**

2-Way Control Valve PN25



Art. No.	Reference	DN	Kvs	Note	Euro/pcs	
21300100	VLC125	15	0.25	1)	243,00	
21300200			0.4		243,00	
21300300			0.63		243,00	
21300400			1		243,00	
21300500			1.6		243,00	
21300600			2.5		243,00	
21300700			4		243,00	
21300800			20		6.3	297,00
21301700		25	32		1.6	297,00
21301800					2.5	297,00
21301900					4	297,00
21302000					6.3	297,00
21300900					10	297,00
21301000					16	341,00
21302100					1.6	368,00
21302200					2.5	368,00
21302300		40	50		4	368,00
21302400					6.3	368,00
21302500					10	368,00
21302600					16	368,00
21301100	25			368,00		
21301200	38			441,00		

VLC225

2-Way Control Valve PN25, With pressure balanced plug.

Art. No.	Reference	DN	Kvs	Note	Euro/pcs
21301300	VLC225	25	10	1)	368,00
21301400		32	16		441,00
21301500		40	25		513,00
21301600		50	38		614,00

VLC3252-Way Control Valve PN25
With a high temperature packing box

Art. No.	Reference	DN	Kvs	Note	Euro/pcs
21350100	VLC325	15	0.25	1)	318,00
21350200			0.4		318,00
21350300			0.63		318,00
21350400			1		318,00
21350500			1.6		318,00
21350600			2.5		318,00
21350700			4		318,00
21350800			20		6.3
21350900		25	10		384,00
21351000		32	16		427,00
21351100		40	25		454,00
21351200		50	38		527,00

VLC4252-Way Control Valve PN25
With pressure balanced plug,
with a high temperature packing box

Art. No.	Reference	DN	Kvs	Note	Euro/pcs
21351300	VLC425	25	10	1)	527,00
21351400		32	16		600,00
21351500		40	25		685,00
21351600		50	38		787,00

CONTROL VALVE

Series VLE300

**VLE325**

2-Way Control Valve PN16

Art. No.	Reference	DN	Kvs	Note	Euro/pcs		
21400100	VLE325	20	0.63	1), 2)	254,00		
21400200			1		254,00		
21400300			1.6		254,00		
21400400			2.5		254,00		
21400500			4		272,00		
21400600			25		32	1	254,00
21400700						1.6	254,00
21400800						2.5	254,00
21400900		4				272,00	
21401000		40	50		1.6	254,00	
21401100					2.5	254,00	
21401200					4	272,00	
21401600					6.3	310,00	
21401300					1.6	264,00	
21401400					2.5	264,00	
21401500					4	286,00	
21401700					6.3	315,00	

Further technical information

On our website you will find loads of useful information like instruction manuals, certificates and technical data. You also might discover some additional article numbers.

Scan the **QR-code** and go to address <http://www.esbe.eu/gb/en/products>



Notes: 1) Stroke 20 mm 2) With premounted flange gasket 3) Stroke 40 mm * The matching connection kit for your valve can be found on page 27.

LINEAR MOTORIZED VALVES

ACTUATOR Series ALA200



Proportional/3-point

ALA221
3-point, 230 V AC

Art. No.	Reference	Running time [20 mm]	Force [N]	Note	Euro/pcs
22000800	ALA221	35	400	4)	366,00
22000200		140	750		300,00

ALA222
3-point, 24 V AC

Art. No.	Reference	Running time [20 mm]	Force [N]	Note	Euro/pcs
22000700	ALA222	35	400	4)	366,00
22000100		140	750		300,00

ALA223
Proportional, 24 V AC/DC

Art. No.	Reference	Running time [20 mm]	Force [N]	Note	Euro/pcs
22000900	ALA222	35	400	1), 4)	419,00
22000300		140	750		352,00

ACTUATOR Series ALB100



Proportional/3-point

ALB144
Proportional/3-point, 24 V AC/DC

Running time by proportional signal;
 [10-25 mm] _____ 15 s
 [10-32 mm] _____ 20 s
 [10-52 mm] _____ 30 s
 by increase/decrease signal; _ 300 s/60 s

Art. No.	Reference	Force [N]	Note	Euro/pcs
22050100	ALB144	800	2), 5)	584,00

ACTUATOR Series ALD100, ALD200



Proportional/3-point

ALD124, ALD224
Proportional/3-point, 24 V AC

Art. No.	Reference	Running time [s]	Force [N]	Note	Euro/pcs
22150200	ALD124	150	900	3), 6)	588,00
22150600			1200		831,00
22150400	ALD224	70	900	3), 6), 8)	2.915,00

ALD144, ALD244
Proportional/3-point, 24 V AC

Art. No.	Reference	Running time [s]	Force [N]	Note	Euro/pcs
22151000	ALD144	300	1200	3), 7)	846,00
22151200			2000		1.357,00
22151400	ALD244	140	2200	3), 7), 9)	3.283,00

ALD121, ALD221
3-point, 230 V AC

Art. No.	Reference	Running time [s]	Force [N]	Note	Euro/pcs
22150100	ALD121	150	900	6)	547,00
22150500			1200		778,00
22150300	ALD221	70	900	6), 8)	2.254,00

ALD141, ALD241
3-point, 230 V AC

Art. No.	Reference	Running time [s]	Force [N]	Note	Euro/pcs
22150900	ALD141	300	1200	7)	780,00
22151100			2000		1.118,00
22151300	ALD241	140	2200	7), 9)	2.621,00

ESBE ACCESSORIES

ADAPTOR KITS

Options actuators

Art. No.	Reference	Actuator			Designation	Euro/pcs
		ALA	ALB	ALD		
26000300	ALA822	●			Ari 12485, 12486, 12487, 12488	61,00
26000400	ALA823	●			Danfoss VF3, VFS2, VRB3, VRG3	43,00
26001000	ALA827	●			Honeywell V5011R, V5013R, V538, V5049A, V5050A, V5328A, V5329A, V5329C, V5095A, V176, V5015	41,00
26000300	ALA822	●			Hora 216GG, 206GG, 306GG, 316GG	61,00
26001100	ALA827	●			Osby/Regin MTV/MTVS, MTR/MTRS, 2SA/2SB, FRS, GTR/RTV/BTRV, GTVS/RTVS, GTRS/RTRS	52,00
26000800	ALA826	●	●		Satchwell VZ, VJF, VSF 15-50, VZF, MZF 65-150	55,00
26000500	ALA824	●			Sauter B6F, B6G, B6R, B6S, BXD, BXE, V6F, V6G, V6R, V6S, VXD, VXE	43,00
26000900	ALA824	●			Sauter BUD, BUE, VUE	54,00
26000100	ALA821	●			Siemens WF 31, VXF 31, VWG 41, VXG 41, WF 52, VXF 21, VXF 41, WF 21	21,00
26000200	ALB841		●		Siemens WF 31, VXF 31, VWG 41, VXG 41, WF 52, WF 61, VXF 61, WF 45, WF 51, VXF 11, VWG 11, VFG 34	106,00
26000600	ALA825	●			Wittler V225T, V206H, V216H, V216R, V306H, V316H, V316R	61,00

Actuator - Notes: 1) 0...10 V, 2...10 V, 0...20 mA or 4...20 mA 2) 0...10V, 2...10V or 3-point 3) 0...10V, 2...10V, 0...20mA, 4...20mA or 3-point control signal 4) Stroke 10-20 mm 5) Stroke 10-52 mm 6) Stroke 20 mm 7) Stroke 40 mm 8) With spring return. Closing time: ~ 5s/20mm 9) With spring return. Closing time: ~ 10s/40mm

ESBE ACCESSORIES

STEM HEATERS

Options actuators



Art. No.	Reference	Actuator			Designation	Euro/pcs
		ALA	ALB	ALD		
26101900	ALA821	•		•	DN 15-50, 24 V	416,00
26102000	ALD841			•	DN 65-150, 24V (stroke 10..45)	216,00

END POSITION CONTACTS

Options actuators

Art. No.	Reference	Actuator			Designation	Euro/pcs
		ALA	ALB	ALD		
26200700	ALB841		•		24 V	111,00

ADAPTOR KIT

Options valves DN15-50



Art. No.	Reference	Designation	Euro/pcs
26000700	VLA821	Adaptor kit Siemens SGX	25,00

CONNECTION KITS

Options valves DN15-50



KTB112

Fittings Internal thread, PN16

Art. No.	Valve thread	Connection Ød	Note	Euro/pcs
26100700	G 1"	Rp ½"	1), With internal thread	11,00
26100800	G 1¼"	Rp ¾"		8,00
26100900	G 1½"	Rp 1"		9,00
26101000	G 2"	Rp 1¼"		15,00
26101100	G 2¼"	Rp 1½"		17,00
26101200	G 2¾"	Rp 2"		27,00

KSB114

Fittings Soldering type, PN16



Art. No.	Valve thread	Connection Ød	Note	Euro/pcs
26101300	G 1"	15 mm	1)	16,00
26101400	G 1¼"	22 mm		17,00
26101500	G 1½"	28 mm		21,00
26101600	G 2"	35 mm		30,00
26101700	G 2¼"	42 mm		40,00
26101800	G 2¾"	54 mm		60,00

KWB118

Fittings Welded type, PN16



Art. No.	Valve thread	Connection Ød	Note	Euro/pcs
26100100	G 1"	21.3 mm	1)	22,00
26100200	G 1¼"	26.9 mm		22,00
26100300	G 1½"	33.7 mm		24,00
26100400	G 2"	42.4 mm		24,00
26100500	G 2¼"	48.3 mm		37,00
26100600	G 2¾"	60.3 mm		47,00

Connection kit - Notes: 1) 1 connection/package

ESBE PRICELIST 2014 GB/EUR

© Copyright. Rights reserved to make alterations.

ESBE SYSTEM COMPONENTS

COMPLEMENTARY PRODUCTS



MANIFOLD Series VMA200

VMA213, VMA233

Compression fitting/internal thread, PN16

Art. No.	Reference	DN	Kvs	Connection		Euro/pcs
36401000	VMA213	15	2.5	CPF 15 mm	G ½"	36,00
36401100				G ½"	40,00	
36401200	VMA233	20	3.5	CPF 22 mm	CPF 22 mm	43,00

SAFETY VALVE

Series VSB100

VSB132

External thread and Compression fitting, PN16

CE PED 97/23/EC TÜV TÜV ACS



Art. No.	Opening pressure		Blow-off capacity*		DN	Connection	Euro/pcs	
	[MPa]	[bar]	[kW] ¹⁾	[l/h] ²⁾				
36020100	0.6	6.0	75	76	15	R ½"	12,00	
36020200	0.7	7.0					12,00	
36020300	0.8	8.0					12,00	
36020400	0.9	9.0					12,00	
36020500	1.0	10.0					12,00	
36020600	1.0	10.0	150	176	20	R ¾"	CPF 22mm	13,00

SAFETY VALVE

Series VSB200

VSB211

Internal thread, PN16

CE PED 97/23/EC TÜV TÜV



Art. No.	Opening pressure		Blow-off capacity*		DN	Connection		Euro/pcs
	[MPa]	[bar]	[kW] ²⁾	[l/h] ²⁾				
36022500	0.15	1.5	115	350	20	Rp ¾"	Rp ¾"	13,00
36022600	0.2	2.0	135	350				13,00
36022700	0.25	2.5	150	425				13,00
36022800	0.3	3.0	165	425				13,00
36022900	0.35	3.5	185	475				13,00
36023000	0.15	1.5	125	350				13,00
36023200	0.25	2.5	165	425				13,00

Safety valve - Notes: * given at specified pressure +20% 1) Acc. to EN-1491 § 9 2) Acc. to EN-1491 § 6.2.4 3) Measurements by supplier

12

13

COMPLEMENTARY PRODUCTS

SAFETY VALVE Series VSB200

VSB232

External thread and Compression fitting, PN16

CE PED 97/23/EC TÜV



Art. No.	Opening pressure		Blow-off capacity*		DN	Connection		Euro/ pcs
	[MPa]	[bar]	[kW] ³⁾	[l/h] ²⁾				
36022000	0.15	1.5	80	175	15	R 1/2"	CPF 15mm	12,00
36022100	0.2	2.0	95	175				12,00
36022200	0.25	2.5	105	200				12,00
36022300	0.3	3.0	115	200				12,00
36022400	0.35	3.5	130	225				12,00
36023500	0.15	1.5	105	175	20	R 3/4"	CPF 22mm	15,00

SAFETY VALVE Series VSB300

VSB311

Internal thread, PN16

CE PED 97/23/EC TÜV



Art. No.	Opening pressure		Blow-off capacity*		DN	Connection		Euro/ pcs
	[MPa]	[bar]	[kW] ³⁾	[a_w] ⁵⁾				
36025000	0.35	3.5	50	0.58	15	G 1/2"	Rp 3/4"	16,00
36025100	0.6	6.0						16,00

FILLING VALVE Series VFA100

VFA103 Compression fitting, PN16

Art. No.	DN	Kvs	Connection	Note	Euro/ pcs
36300100	15	2	CPF 15 mm		28,00



DRAINING VALVE Series VDA100, VDB100

VDA102 External thread, PN16

Art. No.	DN	Connection		Note	Euro/ pcs
36200100	15	G 1/2"	G 1/2"		11,00
36200200		R 1/2"	G 1/2"		12,00



VDB102 External thread, PN16

Art. No.	DN	Connection		Note	Euro/ pcs
36200400	15	G 1/2"	G 1/2"		20,00



CHECK VALVE Series VCA100



VCA100 PN10

Art. No.	DN	Kvs	Opening pressure [kPa]			Euro/ pcs
			↑	→	↓	
36500100	15	1.5	4.0	3.8	3.5	5,00
36500400	20	4.0	2.5	2.3	2.0	5,00
36500500	25	6.0	2.6	2.0	1.4	20,00

VACUUM VALVE Series VVA100



VVA100 External thread, PN10

Art. No.	DN	Connection	Note	Euro/ pcs
36100100	15	G 1/2"		11,00

COPPER PIPE SUPPORTER Series XAA100



Art. No.	Designation	Note	Euro/ pcs
86200100	Copper pipe supporter 8x0.8	100 pcs	30,00
86200200	Copper pipe supporter 8x1.0	100 pcs	34,00
86200300	Copper pipe supporter 10x0.8	100 pcs	28,00
86200400	Copper pipe supporter 10x1.0	100 pcs	29,00
86200500	Copper pipe supporter 12x0.7	100 pcs	36,00
86200600	Copper pipe supporter 12x1.0	100 pcs	34,00
86200800	Copper pipe supporter 15x0.8	100 pcs	64,00
86200900	Copper pipe supporter 15x1.0	100 pcs	38,00
86201000	Copper pipe supporter 18x1.0	50 pcs	26,00
86201100	Copper pipe supporter 22x1.0	50 pcs	28,00
86201200	Copper pipe supporter 28x1.2	50 pcs	36,00
86201400	Copper pipe supporter 12x2.0 PEX	100 pcs	34,00
86201500	Copper pipe supporter 15x2.5 PEX	100 pcs	35,00
86201700	Copper pipe supporter 22x3.0 PEX	50 pcs	29,00

Further technical information

On our website you will find loads of useful information like instruction manuals, certificates and technical data. You also might discover some additional article numbers.

Scan the QR-code and go to address <http://www.esbe.eu/gb/en/products>



ROTARY VALVES



VRG130, VRG330



VRG140, VRB140



VRG230



VRH130

Date code (YYWW)

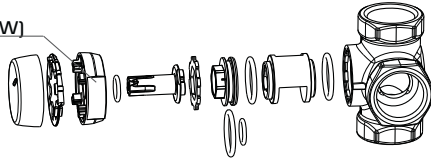

17006900, 17006910,
17006920, 17006930,
17006950



17006940

Valve type	Applies to			Interior complete			Handle knob/Scale		
	Art.No.	DN	from (YYMM)	Reference	Art.No.	Euro/pcs	Reference	Art.No.	Euro/pcs
VRG130	116001xx - 116009xx, 116015xx - 116023xx, 116029xx - 116030xx	15/20		VRG802	17006900	16,00	VRG803	17006940	5,00
	116010xx - 116011xx 116024xx - 116025xx 116031xx	25			17006910	16,00			
	116012xx, 116026xx 116034xx - 116035xx	32/40			17006920	16,00			
	116013xx - 116014xx 116027xx - 116028xx	40/50			17006930	16,00			
	116036xx - 116037xx	50			17006950	8,00			
VRH130	117201xx - 117203xx	25		VRG802	17006910	16,00	VRG803	17006940	5,00
VRG140	116401xx - 116403xx 116408xx - 116410xx	15/20		VRG802	17006900	16,00	VRG803	17006940	5,00
	116404xx, 116411xx	25			17006910	16,00			
	116405xx, 116412xx 116415xx - 116416xx	32/40			17006920	16,00			
	116406xx - 116407xx 116413xx - 116414xx	40/50			17006930	16,00			
	116417xx - 116418xx	50			17006950	8,00			
VRG230	116201xx, 116206xx, 116211xx - 116212xx	20		VRG802	17006900	16,00	VRG803	17006940	5,00
	116202xx, 116207xx, 116213xx	25			17006910	16,00			
	116203xx, 116208xx 116214xx - 116215xx	32/40			17006920	16,00			
	116204xx - 116205xx 116209xx - 116210xx	40/50			17006930	16,00			
	116216xx - 116217xx	50			17006950	8,00			
VRG330	117001xx, 117006xx	20		VRG802	17006900	16,00	VRG803	17006940	5,00
	117002xx, 117007xx	25			17006910	16,00			
	117003xx, 117008xx 117011xx - 117012xx	32/40			17006920	16,00			
	117004xx - 117005xx 117009xx - 117010xx	40/50			17006930	16,00			
	117013xx - 117014xx	50			17006950	8,00			
VRB140	116601xx - 116602xx 116608xx - 116609xx 116615xx - 116616xx	15/20		VRG802	17006900	16,00	VRG803	17006940	5,00
	116604xx, 116611xx, 116617xx	25			17006910	16,00			
	116605xx, 116612xx 116620xx - 116621xx	32/40			17006920	16,00			
	116606xx - 116607xx 116613xx - 116614xx	40/50			17006930	16,00			
	116622xx - 116623xx	50			17006950	8,00			

ROTARY VALVES



3MG



3MGP



3HG



17000600



17002400, 17002500,
17004300



17007500

Valve type	Applies to		Interior complete			Handle knob/Lever			Joining set		
	Art.No.	up to (YYMM)	Reference	Art.No.	Euro/pcs	Reference	Art.No.	Euro/pcs	Reference	Art.No.	Euro/pcs
3MG15 - 3MG28 (Kvs 0.6-8)	11000100		3MG-1	17002400	48,00	MG	17007500	4,00	MG	17000600	11,00
	11000200										
	11000300										
	11000400										
	11000500										
	11000700										
	11001100										
3MGP15 - 3MGP25 (Kvs 2.5-8)	11005500		3MG-2	17002500	41,00	MG	17007500	4,00	MG	17000600	11,00
	11005600										
	11002000										
3MG25 -12 3MG32 -18 (Kvs 12-18)	11002400 11002700										
3MGP32 (Kvs 18)	11005700										
3HG25	11350500		3HG	17004300	54,00						
	11351200										



4MG



4HG



TM



5MG



BIV20



17000600



17003700, 17003800,
17004100, 17004200,
17004400



17007500

Valve type	Applies to		Interior complete			Handle knob/Lever			Joining set		
	Art.No.	up to (YYMM)	Reference	Art.No.	Euro/pcs	Reference	Art.No.	Euro/pcs	Reference	Art.No.	Euro/pcs
4MG15 - 4MG25 (Kvs 2.5-8)	11003400		4MG-1	17003800	45,00	MG	17007500	4,00	MG	17000600	11,00
	11003600										
	11003900										
	11004200										
4MG25 -12 4MG32 -18 (Kvs 12-18)	11004700		4MG-2	17004100	50,00						
	11004900										
4HG25 -8 4HG25 -6.3	11350100		TM/HG-1	17003700	45,00						
	11350200										
4HG25 -10	11350800		TM-2/HG-2	17004200	57,00						
	11351100										
TM22	11300400	9412	TM/HG-1	17003700	45,00						
TM20	11300400		TM-2/HG-2	17004200	57,00						
5MG25 -8 5MG32 -18	11005200		-								
	11005300										
BIV20 BIV22	11450100		BIV20-22	17004400	69,00						
	11450300										

ROTARY VALVES

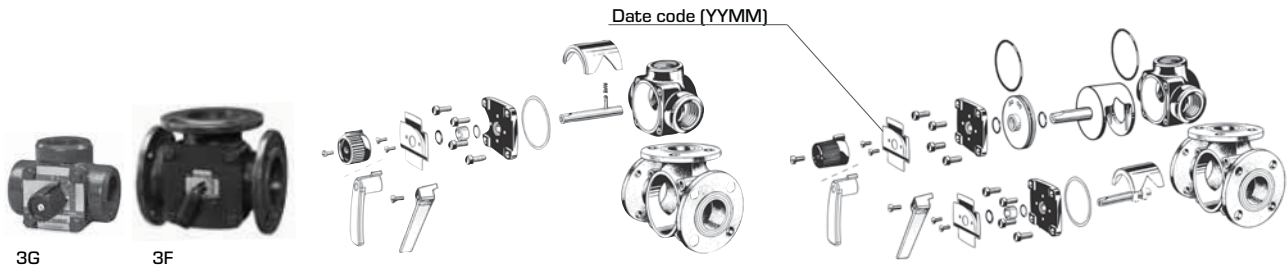

17000300



17000400



17000800



17001100, 17001400,
17001700, 17001800,
17002000, 17002100, 17004500



98080120

Valve type	Applies to		Interior complete			Handle knob/Lever			Joining set		
	Art.No.	up to (YYMM)	Reference	Art.No.	Euro/pcs	Reference	Art.No.	Euro/pcs	Reference	Art.No.	Euro/pcs
G119 - 138	11050100 11050200 11050300 11050400	9605	K1C	17000800	59,00						
G151	11050600	9612	K2A-S	17001100	107,00				No. 1 (DN 20-65)	17000300	16,00
F120-125	110 - 111	9605	K1C	17000800	59,00						
F132-140	112 - 113	9612	K2A-S	17001100	107,00						
F150-165	11100600 115	9012	-			Lever*	98080120	5,00			
F180	116		-								
F1100	117		K5A-S	17001800	275,00				No. 2 (DN 80-150)	17000400	16,00
F1125	118		-								
F1150	119		K6-S	17002100	438,00						
3H25	11351500			3H25	17004500	123,00				No. 1 (DN 20-65)	17000300

Valve type	Applies to		Interior complete			Handle knob/Lever			Joining set		
	Art.No.	from (YYMM)	Reference	Art.No.	Euro/pcs	Reference	Art.No.	Euro/pcs	Reference	Art.No.	Euro/pcs
3G20 - 40	11050100 11050200 11050300 11050400	9606	K1C	17000800	59,00						
3G50	11050600	9701	K2A-S	17001100	107,00				No. 1 (DN 20-65)	17000300	16,00
3F20 - 25	11100100 11100200	9606	K1C	17000800	59,00						
3F32 - 40	11100300 11100400	9701	K2A-S	17001100	107,00						
3F50 - 65	11100600 11000800	9101	K3A-S	17001400	140,00	Lever	98080120	5,00			
3F80	11101000		K4-S	17001700	217,00						
3F100	11101200		K5A-S	17001800	275,00				No. 2 (DN 80-150)	17000400	16,00
3F125	11101400		K5B-S	17002000	330,00						
3F150	11101600		K6-S	17002100	438,00						
3H32 - 40	11351700 11351900			3H32-40	17004600	123,00				No. 1 (DN 20-65)	17000300

Notes: *Replaces Handle knob Art.No. 17007500 and Lever Art.No. 98360010

ESBE SPARE PARTS
ROTARY VALVES

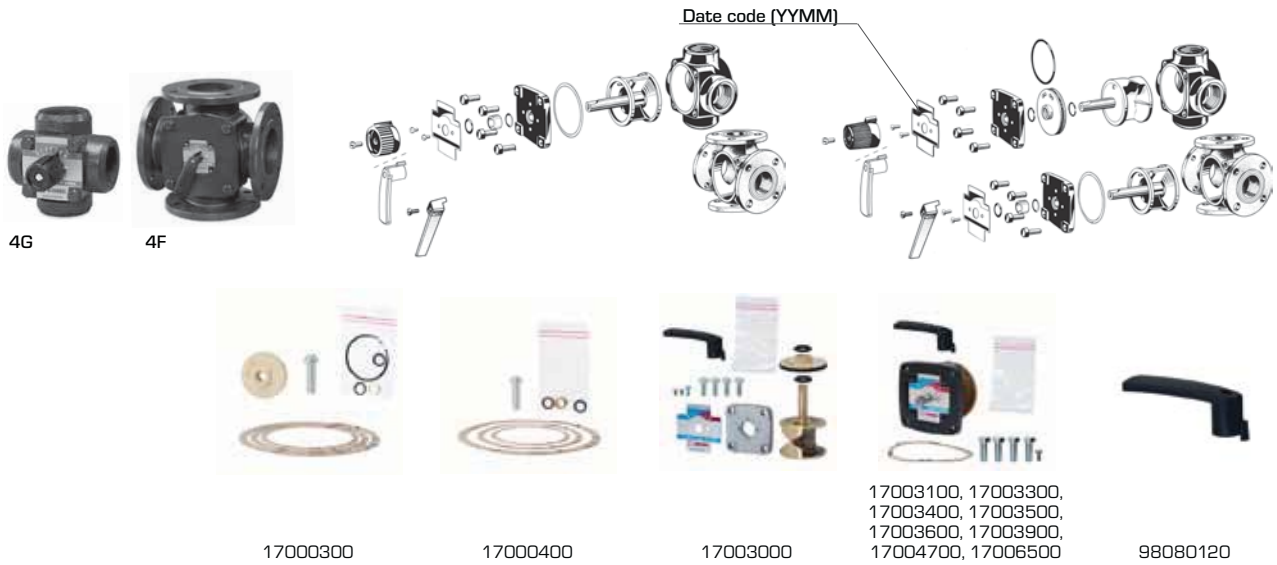

Valve type	Applies to		Interior complete			Handle knob/Lever			Jointing set					
	Art.No.	up to (YYMM)	Reference	Art.No.	Euro/pcs	Reference	Art.No.	Euro/pcs	Reference	Art.No.	Euro/pcs			
G419 - 438	11050800 11051000 11051300 11051400	9605	V1	17003000	59,00	Lever*	98080120	5,00	No. 1 (DN 20-65)	17000300	16,00			
G451	11051600		V2A	17003100	116,00									
F432-440	11101700 11101800		V3A	17003300	155,00									
F450-465	11101900 11102000		V4	17003400	233,00									
F480	11102100		V5	17003500	261,00				No. 2 (DN 80-150)	17000400	16,00			
F4100 - 4125	11102200 11102300		-											
F4150	11102400		-											

Valve type	Applies to		Interior complete			Handle knob/Lever			Jointing set					
	Art.No.	from (YYMM)	Reference	Art.No.	Euro/pcs	Reference	Art.No.	Euro/pcs	Reference	Art.No.	Euro/pcs			
4G20 - 40	11050800 11051000 11051300 11051400	9606	V1	17003000	59,00	Lever	98080120	5,00	No. 1 (DN 20-65)	17000300	16,00			
4G50	11051600		V2A	17003100	116,00									
4F32 - 40	11101700 11101800		V3A	17003300	155,00									
4F50 - 65	11101900 11102000		V4	17003400	233,00									
4F80	11102100		V5	17003500	261,00				No. 2 (DN 80-150)	17000400	16,00			
4F100 - 125	11102200 11102300		-											
4F150	11102400		-											
4H20 - 25	11351300 11351400		V1T	17006500	59,00				No. 1 (DN 20-65)	17000300	16,00			
4H32 - 40	11351800 11352000		4H32 - 40	17004700	123,00									
T20 - 32	11300900 11301000 11301100		V1T	17006500	59,00									
BIV25	11450200	BIV25	17003900	85,00										

ROTARY VALVES



KTD100



36553500 -
36553900

Applies to		Gasket kit, 4pcs/ kit		
Art.No.	For adapter	Reference	Art.No.	Euro/pcs
36551700	G 1" → G ¾"	KTD901	36553500	9,00
36551800	G 1¼" → G 1"		36553600	12,00
36551900	G 1½" → G 1¼"		36553700	14,00
36552000	G 2" → G 1½"		36553800	15,00
36552100	G 2¼" → G 2"		36553900	21,00

CIRCULATION UNITS



GDx, GFx, GRx, GBx



67000100



67000200

Applies to		Type	Reference	Art.No.	Euro/pcs
61000100 - 61060200		Pump RKA25/6	GSP901	67000100	240,00
		Thermometers 2 pcs/package	GSP902	67000200	28,00

ROTARY ACTUATORS



ARA600

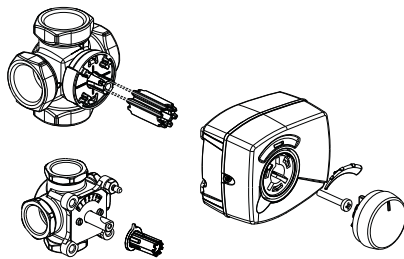

16000400



16000500



17050600

Applies to		Adaptor kit			Knob		
Actuator type	Valves series	Reference	Art.No.	Euro/pcs	Reference	Art.No.	Euro/pcs
ARA600	MG, G, F, BIV, T, TM, H, HG	ARA802	16000400	6,00	ARA902	17050600	5,00
	VRG, VRB, MG, G, F, BIV, T, TM, H, HG	ARA803	16000500	8,00			



M60

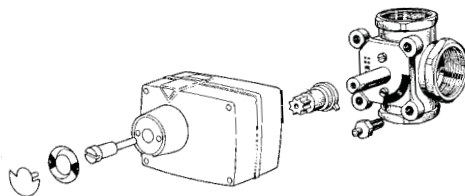

16000100



98080690

Applies to		Adaptor kit			Shaft coupling		
Actuator type	Valves series	Reference	Art.No.	Euro/pcs	Reference	Art.No.	Euro/pcs
60	MG, G, F, BIV, T, TM, H, HG	600	16000100	10,00	600	98080690	2,00



M90

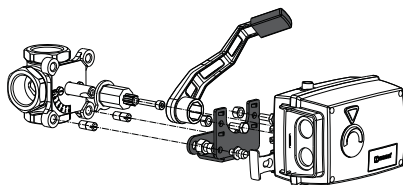

16053300



16051300



98180570

Applies to		Adaptor kit			Shaft coupling		
Actuator type	Valves series	Reference	Art.No.	Euro/pcs	Reference	Art.No.	Euro/pcs
90	VRG, VRB	VRG801	16053300	15,00	900	98180570	3,00
	MG, G, F, BIV, T, TM, H, HG	900	16051300	11,00			

CONTROLLERS



90C-1, 90C-2, 90C-3



95-1C



16053700



16053200



16200200

Applies to		Adaptor kit		
Controller type	Valves series	Reference	Art.No.	Euro/pcs
90C-1 90C-2 90C-3	VRG, VRB, VRH	VRG804	16053700	15,00
95-1C	MG, G, F, BIV, T, TM, H, HG	90C	16053200	11,00



17050100



17050200,
17050500, 17050800



17050300

Applies to Controller type	Type	Sensors		
		Reference	Art.No.	Euro/pcs
90C-1 90C-2 90C-3	Room sensor	CRS231	17050700	108,00
	Flow pipe sensor	CRS211	17050800	41,00
	Universal sensor	CRS213	17050900	41,00
	Outdoor sensor	CRS214	17051000	51,00
	High temperature sensor	CRS215	17051100	108,00
95-1C	Room sensor with room temperature influence	RT21	16200200	144,00
	Fuse	-	17050100	2,00
	Pipe sensor	-	17050200	51,00
	Outdoor sensor	-	17050300	79,00
	Water sensor	-	17050400	48,00



17050400,
17050900, 17051100



17050700



17051000



16053300



16051300



98180570



90K

Applies to Controller type	Valves series	Adaptor kit			Shaft coupling			Pipe sensor		
		Reference	Art.No.	Euro/pcs	Reference	Art.No.	Euro/pcs	Reference	Art.No.	Euro/pcs
90K	VRG, VRB, VRH	VRG801	16053300	15,00	900	98180570	3,00	-	17050500	59,00
	MG, G, F, BIV, T, TM, H, HG	900	16051300	11,00						

LINEAR ACTUATORS



ALC100 22100200 - 22100400

Applies to Actuator type	Type	Reference	Art.No.	Euro/pcs
ALC100	Actuator, 3-point 230V 300N 66s	ALC151	22100200	251,00
	Actuator, 3-point 230V 300N 33s		22100400	258,00
	Actuator, 3-point 24V 300N 66s	ALC152	22100100	227,00
	Actuator, Proportional 24V 300N 13s	ALC153	22100300	321,00

CONTROLLERS



CRA11x, CRB, CRC



16000500



16053300



16051300



CRA120



17053100



17053300



17053500



17054100



CUA



17055100



17055300, 17055500



17055700



17056000

Applies to Controller type				Adaptor kits			
CRA11x,	CRA12x	CRB	CRC	Applies to valves series	Reference	Art.No.	Euro/pcs
•		•	•	VRG, VRB, VRH, MG, G, F, BIV, T, TM, H, HG	ARA803	16000500	8,00
	•			VRG, VRB, VRH	VRG801	16053300	15,00
	•			MG, G, F, BIV, T, TM, H, HG	900	16051300	11,00

Applies to Controller type				Sensors, adaptors, cables etc.			
CRA11x, CRA12x	CRB	CRC	CUA	Type	Reference	Art.No.	Euro/pcs
•	•	•	•	Flow pipe sensor, 5m cable	CRA911	17053100	26,00
•	•	•	•	Voltage adaptor, 230V – 24V	CRA912	17053300	21,00
•	•	•	•	Cable, 24V	CRA913	17053500	4,00
	•	•	•	Communication cable, 20m	CRB914	17055700	26,00
		•		Outdoor sensor	CRC911	17056000	50,00
	•			Controller (CRB122 without room unit)	CRB911	17055100	353,00
	•		•	Room unit, cable	CRB912	17055300	146,00
	•		•	Room unit, wireless	CRB913	17055500	207,00
			•	Controller (CUA110 without room unit)	CUA911	17054100	243,00

SOLID FUEL PRODUCTS



VTC300



57000100 -
57000600



TV



17006800 -
17007400

Applies to Valve type	Thermostat			
	Type	Reference	Art.No.	Euro/pcs
VTC300	42°C	VTC931	57000600	17,00
	45°C		57000100	17,00
	55°C		57000200	17,00
	60°C		57000300	17,00
	70°C		57000400	17,00
	80°C		57000500	17,00

Applies to Valve type	Art.No.	Interior complete		
		Type	Art.No.	Euro/pcs
TV45°C	11400600, 11401100, 11401500	45°C	17007300	71,00
TV55°C	11400700, 11401200, 11401600	55°C	17007400	71,00
TV60°C	11400400, 11400800, 11401300	60°C	17006800	71,00
TV72°C	11400100, 11400200, 11400300	72°C	17007000	71,00

SOLID FUEL PRODUCTS



LTC100



LTC200



VTC510



VTC530

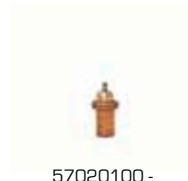

57020100 -
57020500



57020600



57060100



57020700



57060200 -
57060300



57061100



57060400



57060500 -
57061000

Applies to Valve type				Type	Reference	Art.No.	Euro/pcs
LTC100	LTC200	VTC510	VTC530				
•	•	•	•	Thermostat 50°C	VTC951	57020100	21,00
•	•	•	•	Thermostat 55°C		57020200	21,00
•	•	•	•	Thermostat 60°C		57020300	21,00
•	•	•	•	Thermostat 65°C		57020800	21,00
•	•	•	•	Thermostat 70°C		57020400	21,00
•	•	•	•	Thermostat 75°C		57020500	21,00
•	•			Thermometer, 3pcs	VTC952	57020600	43,00
•	•			Insulation, complete in two parts	VTC953	57060100	36,00
			•	Insulation, ≥ DN32, complete in two parts		57020700	29,00
•	•	•	•	Jointing set VTC/LTC, 3pcs of fibre gasket 1½"	LTC922	57020900	3,00
•				Pump DS RS 25/4	LTC914	57060200	156,00
•				Pump DS RS 25/7	LTC917	57060300	184,00
	•			Pump Yonos Para /6 RKA	LTC926	57061100	252,00
•	•			Non-return insert	LTC921	57060400	11,00
•	•	•	•	Shut-off valves / Adapters 1½" x 1" 3pcs	LTC801	57060500	61,00
•	•	•	•	Shut-off valves / Adapters 1½" x 1¼" 3pcs		57060600	63,00
•	•	•	•	Shut-off valves / Adapters 1½" x 1½" 3pcs		57060700	80,00
•	•	•	•	Shut-off valves / Adapters 1½" x 2" 3pcs		57060800	106,00
•	•	•	•	Shut-off valves / Adapters 1½" x CPF 28mm 3pcs		57060900	71,00
•	•	•	•	Shut-off valves / Adapters 1½" x CPF 35mm 3pcs		57061000	82,00
•	•	•	•				



ATA100



ATA200



37200900



57100100



57100200



37201000, 37202500,
37202600

Applies to Valve type		Type	Reference	Art.No.	Euro/pcs
ATA100	ATA200				
•		Handle knob	ATA901	37200900	5,00
•	•	Fork		57100100	5,00
	•	Eccentric		57100200	4,00
•		Thermostat 40 - 95°C	ATA902	37201000	11,00
	•	Thermostat 35 - 95°C		37202500	11,00
	•	Thermostat 60 - 95°C		37202600	11,00

THERMOSTATIC MIXING VALVES



VTA300

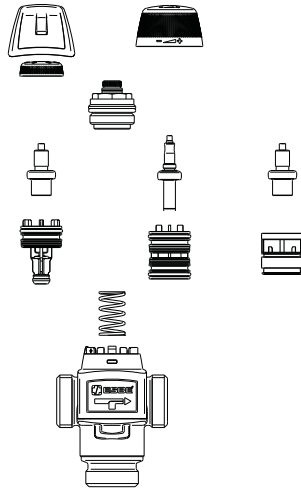

98080420



98080480



98080440



98082130



37000400, 37000500,
37000700, 37001300,
37001400



37000100, 37000200,
37000800, 37000900



37001100,
37001200

Applies to		Exchange kit			
Valve type	Art. No.	Reference	Temp.	Art.No.	Euro/pcs
VTA310		VTA931	35 - 60°C	37000700	40,00
			30 - 70°C	37001400	50,00
VTA320		VTA932	35 - 60°C	37000400	35,00
			20 - 43°C	37000500	45,00
VTA330		VTA933	30 - 70°C	37001300	50,00
			35 - 60°C	37000100	51,00
VTA350		VTA936	32 - 49°C	37000200	51,00
			35 - 60°C	37000800	51,00
VTA360		VTA936	35 - 60°C	37000800	51,00
			32 - 49°C	37000900	51,00
VTA370	3110 44 00	VTA932	20 - 43°C	37000500	45,00
			35 - 60°C	37000400	35,00
	3110 40 00, 3110 45 00	VTA937	20 - 43°C	37001200	50,00
			35 - 60°C	37001100	50,00

Applies to Valve type						Knob		
VTA 310	VTA 320	VTA 330	VTA 350	VTA 360	VTA 370	Ref.	Art.No.	Euro/pcs
	●	●	●	●	●*	VTA903	98080420	5,00
	●	●	●	●	●*		98080480	4,00
●							98080440	5,00
					●		98082130	5,00

Notes: * Applies to Art. No. 3110 40 00, 3110 44 00, 3110 45 00

ESBE PRICELIST 2014 GB/EUR
© Copyright. Rights reserved to make alterations.



VTA500,
VTS500

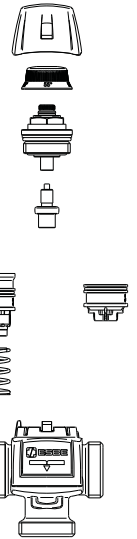

37100400 - 37100600,
37100900 - 37101000,
37101100 - 37101300,
37120300 - 37120400

37100100 - 37100300,
37100700 - 37100800,
37101100 - 37101300,
37120100 - 37120200

Applies to		Exchange kit			
Valve type	Art. No.	Reference	Temp.	Art.No.	Euro/pcs
VTA520		VTA952	20 - 43°C	37100100	44,00
			45 - 65°C	37100200	44,00
			50 - 75°C	37100300	44,00
VTA550		VTA955	20 - 43°C	37100400	44,00
			45 - 65°C	37100500	44,00
VTA530		VTA953	50 - 75°C	37100600	44,00
			45 - 65°C	37100700	44,00
VTA560		VTA956	35 - 50°C	37100800	44,00
			45 - 65°C	37100900	44,00
VTA570		VTA957	35 - 50°C	37101000	44,00
			10 - 30°C	37101100	44,00
VTS520		VTS952	20 - 43°C	37101200	44,00
			45 - 65°C	37101300	44,00
VTS550		VTS955	45 - 65°C	37120100	44,00
			50 - 75°C	37120200	44,00
			45 - 65°C	37120300	44,00
			50 - 75°C	37120400	44,00



APPLIES TO

Series VTA500, VTS500 with adapters
+
Connection kit series
KCD300, KSD300, KTD200, KTD300



36553500,
36553600

Applies to		Gasket kit, 4pcs/ kit		
For adapter	Reference	Art.No.	Euro/pcs	
G 1" → R ¾" / CPF 22mm	KTD901	36553500	9,00	
G 1¼" → R 1" / CPF 28mm		36553600	12,00	

THERMOSTATIC MIXING VALVES



Series 20, VTA100



Series AS, VTA200

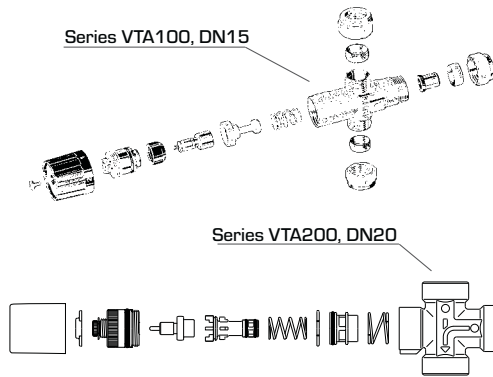

Series VTA100, DN15

Series VTA200, DN20

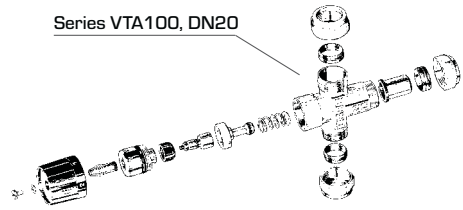

Series VTA100, DN20

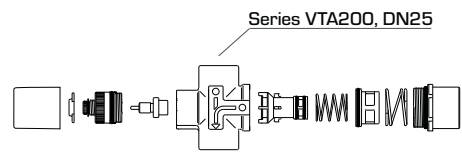

Series VTA200, DN25



98080180,
98080150



98161770,
98161780



98161790,
98161800



36500100 -
36500500



37051600,
37051700



37050400 -
37051500, 37052100

Applies to		Handle knob		Compression nut		Compression ring		Check valve*		Exchange kit	
Art. No.	DN, Temp.	Art.No.	Euro/pcs	Art.No.	Euro/pcs	Art.No.	Euro/pcs	Art.No.	Euro/pcs	Art.No.	Euro/pcs
401, 410	DN15 38 - 65°C	98080180	5,00	98161770	3,00	98161790	1,00	36500100	5,00	37051700	33,00
401L, 410L (411)	DN15 20 - 40°C									-	-
403, 404, 405, 414, 417, 418 (402, 406, 409)	DN20 38 - 65°C	98080150	5,00	98161780	3,00	98161800	1,00	36500400	5,00	37051600	37,00
403L 404L	DN20 20 - 40°C									-	-

Applies to		Check valve*			Exchange kit		
Art. No.	DN, Kv, Temp.	Ref.	Art.No.	Euro/pcs	Ref.	Art.No.	Euro/pcs
470 - 475	DN 20 - 25, Kv 1.6, 38 - 65°C	VCA100, 20	36500400	5,00	VTA922	37050400	43,00
470L - 475L	DN 20 - 25, Kv 1.6, 20 - 40°C					37050800	43,00
	DN 20, Kv 1.6, 20 - 40°C					37052100	50,00
	DN 20, Kv 1.6, 30 - 70°C					37052000	50,00
31300100, 31301200	DN25, Kv 3.0, 38 - 65°C	VCA100, 28	36500500	20,00	VTA922	37051000	43,00
31300700	DN25, Kv 3.0, 20 - 40°C					37051400	43,00
31300800	DN25, Kv 3.0, 10 - 30°C					37051500	47,00



VMC300



VMC500



37102000 -
37102200



37100400,
37120300



57000600

Applies to Valve type		Type	Reference	Art.No.	Euro/pcs
VMC300	VMC500				
•	•	Exchange kit 45°C	VTD911	37102000	35,00
•	•	Exchange kit 50°C		37102100	35,00
•	•	Exchange kit 60°C		37102200	35,00
•		Exchange kit, series VTA550, 20 - 43°C	VTA955	37100400	44,00
	•	Exchange kit, series VTS550, 45 - 65°C	VTS955	37120300	44,00
•		Thermostat 45°C	VTC931	57000600	17,00

Notes: * Applies to models with compression fittings on the cold water inlet

DIVERTING VALVES



VTD300 VTD500



37102000 - 37102300 37102400

Applies to Valve type		Type	Reference	Art.No.	Euro/pcs
VTD300	VTD500				
•		Exchange kit 45°C	VTD911	37102000	35,00
•		Exchange kit 50°C		37102100	35,00
•		Exchange kit 60°C		37102200	35,00
•		Exchange kit 70°C		37102300	35,00
	•	Exchange kit,, 40 - 52°C	VTD958	37102400	44,00



VZA, VZB, VZC, VZD



46050100 - 46050400



47050200 - 47050500



47000100

Applies to type					Type	Reference	Art.No.	Euro/pcs
VZA 4302xxxx 4304xxxx	VZA 4300xxxx	VZB	VZC	VZD				
•		•	•	•	Cable fixed version IP40, 3-wire	ALZ801	46050100	17,00
•		•	•	•	Cable loose version IP20, 3-wire		46050300	17,00
•		•	•	•	Cable fixed version IP40, 6-wire for use with Auxiliary switch		46050200	27,00
•		•	•	•	Cable loose version IP20, 6-wire for use with Auxiliary switch		46050400	27,00
•	•	•	•	•	Actuator, 2-point 230V IP40	ALZ960	47050200	81,00
•	•	•	•	•	Actuator, 2-point 230V IP20		47050400	81,00
•	•	•	•	•	Actuator, 2-point 230V IP40 with Auxiliary switch	ALZ950	47050300	93,00
•	•	•	•	•	Actuator, 2-point 230V IP20 with Auxiliary switch		47050500	93,00
•	•	•			Valve interior complete	VZA900	47000100	36,00

LINEAR VALVES



VLA, VLB, VLC

Applies to valve type			Type	Reference	Art.No.	Euro/pcs
VLAxxx	VLBxxx	VLC3xx				
•			Exchange kit Packing box	VLA901	27000100	80,00
	•		Exchange kit Packing box	VLB901	27000700	94,00
		•	Exchange kit High temperature packing box for media temperatures up to 180°C	VLC901	27000200	80,00



27000100 - 27000700



Connection kit series KTB100, KSB100, KWB100









For adapter connection			Gasket kit, 4pcs/ kit		
KTB100	KSB100	KWB100	Reference	Art.No.	Euro/pcs
G 1" → Rp 1/2"	15mm	21.3mm	KTD901	36553500	9,00
G 1 1/4" → Rp 3/4"	22mm	26.9mm		36553600	12,00
G 1 1/2" → Rp 1"	28mm	33.7mm		36553700	14,00
G 2" → Rp 1 1/4"	35mm	42.4mm		36553800	15,00
G 2 1/4" → Rp 1 1/2"	42mm	48.3mm		36553900	21,00
G 2 3/4" → Rp 2"	54mm	60.3mm		36554000	21,00







36553500 - 36554000

REPLACEMENT GUIDE





ROTARY MIXING VALVES

ESBE discontinued series		ESBE today series			
					
					
					
Art. No.	Type	Art. No.	Type	See page	
11000100	3 MG 15	11600500	VRG131	5	
11000700	3 MG 20	11600800	VRG131		
11001100	3 MG 20	11600900	VRG131		
11001600	3 MG 25	11601000	VRG131		
11002400	3 MG 25	11601100	VRG131		
11002700	3 MG 32	11601200	VRG131		
11002100	3 MG 22	11603000	VRG133		
11002300	3 MG 28	11603100	VRG133		
11050400	3 G 40	11603400	VRG131		5
11050600	3 G 50	11603600	VRG131		
11003400	4 MG 15	11640100	VRG141	6	
11003600	4 MG 20	11640200	VRG141		
11003900	4 MG 20	11640300	VRG141		
11004700	4 MG 25	11640400	VRG141		
11004900	4 MG 32	11640500	VRG141		
11051400	4 G 40	11641500	VRG141		6
11051600	4 G 50	11641700	VRG141		
11450200	BIV 25	11660400	VRB141	7	
11450100	BIV 20	11660900	VRB142		
11450300	BIV 22	11661500	VRB143		

CONTROLLERS



ESBE discontinued series		ESBE today series		
				
				
Art. No.	Type	Art. No.	Type	See page
12600100	95-1C	12601100	90C-1A	10
12700100	92K2	12742200	CRA122	10
12700200	94K2	12720100	CRA111	
12700500	99K2	12742100	CRA121	

SOLID FUEL PRODUCTS





ESBE discontinued series		ESBE today series		
				
Art. No.	Type	Art. No.	Type	See page
11400600	TV25, 45°C	51020100	VTC511	16
11400700	TV25, 55°C	51020200		
11400400	TV25, 60°C	51020300		
11400100	TV25, 72°C	51020400		
11401100	TV32, 45°C	51020600	VTC511	16
11401200	TV32, 55°C	51020700		
11400800	TV32, 60°C	51020800		
11400200	TV32, 72°C	51020900		
11401500	TV40, 45°C	51026500	VTC531	15
11401600	TV40, 55°C	51026600		
11401300	TV40, 60°C	51026700		
11400300	TV40, 72°C	51026800		
31800200	C20/ATA100, G 3/4"	56001500	ATA212	16
31800300	C20/ATA100, G 1"	56001200		

The purpose of the replacement guide is to assist you in finding the best replacement for an existing product. It is up to the user of this guide to make the final judgement of which product to choose and check that the application specific requirements are fulfilled.

ROTARY ACTUATORS

ESBE discontinued series		ESBE today series		
				
Art. No.	Type	Art. No.	Type	See page
12000100	62	12100300	ARA663	8
12000800	63	12100400	ARA673	
12000500	62M	12100800	ARA664	
12000900	63M	12100900	ARA674	
12001000	65	12101200	ARA651	
12001400	66	12101300	ARA661	
12002000	67	12101400	ARA671	
12002100	67-20	12101500	ARA691	
12001100	65M	12101700	ARA652	
12001500	66M	12101800	ARA662	
12002300	67M	12101900	ARA672	
12002200	67-20M	12102000	ARA692	8
12002700	68	12120900	ARA655	
12002900	68M	12121200	ARA656	
12500100	62P	12520200	ARA659	8

THERMOSTATIC MIXING VALVES

ESBE discontinued series		ESBE today series			
					
					
Art. No.	Type	Art. No.	Type	See page	
31301200	VTA222, 38-65°C	31620200	VTA522	20	
31301600	VTA222, 20-40°C	31620100	VTA522		
31300100	VTA223, 38-65°C	31621700	VTA523	20	
31300700	VTA223, 20-40°C	31621600	VTA523		
31300800	VTA223, 10-30°C	-	-	-	
31301300	VTA272, 20-40°C	31700200	VTA572	22	
470	20-AS, 38-65°C	31100200	VTA323	20	
470L	20-AS, 20-40°C	31100100	VTA323		
476	28-AS, 38-65°C	31621700	VTA523	20	
476L	28-AS, 20-40°C	31621600	VTA523		
472	15R-AS, 38-65°C	31100400	VTA321	20	
472L	15R-AS, 20-40°C	31100300	VTA321		
474	20R-AS, 38-65°C	31100800	VTA321		
474L	20R-AS, 20-40°C	31100700	VTA321		
471	20RA-AS, 38-65°C	31100600	VTA322		
471L	20RA-AS, 20-40°C	31100500	VTA322		
475	25RA-AS, 38-65°C	31101000	VTA322		
475L	25RA-AS, 20-40°C	31100900	VTA322		
401	15, 38-65°C	31050100	VTA313		22
401L	15, 20-40°C	31102600	VTA323		20
403	18, 38-65°C	31050300	VTA313	22	
404	20, 38-65°C	31050400	VTA313		
404L	20, 20-40°C	31100100	VTA323	20	
416	28, 38-65°C	31621700	VTA523	20	
406	15R, 38-65°C	31100400	VTA321	20	
407	20R, 38-65°C	31100800	VTA321		
410	15RA, 38-65°C	31050200	VTA312	22	
410L	15RA, 20-40°C	31102800	VTA322	20	
408	20RA, 38-65°C	31100600	VTA322		
409	25RA, 38-65°C	31101000	VTA322		
414	20K, 35-60°C	31350500	VTA323		

ESBE REPRESENTED IN

Austria

ESBE GmbH
Tel: +49 8131-99667-0
www.esbe.de

Belgium

Euro-Index
Tel: +32 2 757 92 44
www.euro-index.be

Croatia

Petrokov d.o.o
Tel: +385 1 363 8344
www.petrokov.hr

Czech Republic

Remak a.s.
Tel: +420 571 877 778
www.esbe.cz

Denmark

ESBE Denmark (ESBE AB, Sweden)
Tel: +45 75655011
www.esbe.eu

Estonia

SB Keskkütteseadmed AS
Tel: +372 67 75 845
www.esbe.ee

Finland

Oy Callidus Ab
Tel: +358 9 374 751
www.callidus.fi

France

ESBE S.a.r.l.
Tel: +33 (0) 1 47 90 07 26
www.esbe.fr

Germany

ESBE GmbH
Tel: +49 8131-99667-0
www.esbe.de

Greece

Thermovent Hellas A.E.
Tel: +30 210 988 7400
www.thermovent.gr

Great Britain

ESSCO Controls Ltd
Tel: +44 1489 779 068
www.esscocontrols.co.uk

Hungary

Két Kör Kft
Tel: +36 23 530-570
www.ketkorkft.hu

Ireland

EPH Controls Ltd.
Tel: +353 21 434 6238
www.ephcontrols.com

Italy

ESBE S.r.l.
Tel: +39 059 280094
www.esbe-italia.it

Latvia

Vaks Serviss SIA
Tel: +371 67816227

Lithuania

Vilterma Ltd.
Tel: +370 5 2742 788
www.vilterma.lt

Norway

ESBE AB
Tel: +46 (0)371 - 570 000
www.esbe.eu

Poland

ESBE Hydronic Systems Sp. z o.o.
Tel: +48 61 85 10 728
www.esbe.pl

Portugal

Termotecnia Lda
Tel: +351 258 825 206
www.termotecnia.com

Romania

Markus Automatik Srl
Tel: +40 21 334 00 40
www.markus.ro

Russia

Impuls
Tel: +7 - 495 992 6989
www.impulsgroup.ru

Slovakia

Remak a.s.
Tel: +420 571 877 778
www.esbe.cz

Slovenia

VETO Veletrgovina d.o.o.
Tel: +386 158 09 121
www.veto.si

Spain

Salvador Escoda S.A.
Tel: +34 93 446 27 80
www.salvadorescoda.com

Sweden

ESBE AB
Tel: +46 (0)371 - 570 000
www.esbe.eu

Turkey

ESBE Türkiye Ofisi
Tel: +90 216 5770 898
www.esbe.com.tr

Ukraine

Afriso LLC
Tel: +38 044 332 01 32
www.afriso.com.ua

ESBE COMPANIES

Sweden • Head office and factory

ESBE AB
Bruksgatan 22
SE-330 21 Reftele
Tel: +46 (0)371 - 570 000
Fax: +46 (0)371 - 570 020
E-Mail: sales@esbe.eu
www.esbe.se

Denmark

ESBE Danmark, filial af ESBE AB i Sverige
Svinballevej 35
DK-8350 Hundslund
Tel: +45 75655011
Email: joern.nissen@esbe.eu
www.esbe.eu

Germany, Austria

ESBE GmbH
Newtonstr: 14
DE-85221 Dachau
Tel: +49 (0)8131 99 667-0
Fax: +49 (0)8131 99 667-77
E-Mail: info.de@esbe.eu
www.esbe.de

France

ESBE S.a.r.l.
14 Rue du Fossé Blanc Bat A1
FR-92230 Gennevilliers
Tel: +33 (0) 1 47 90 07 26
Fax: +33 (0) 1 47 91 17 13
E-Mail: info@esbe.fr
www.esbe.fr

Italy

ESBE S.r.l.
Via G.Perlasca 20
IT- 41126 Modena
Tel: +39 059 280094
Fax: +39 059 281913
E-Mail: info.it@esbe.eu
www.esbe-italia.it

Turkey

ESBE Türkiye Ofisi
Kayışdağı Caddesi,
Cengizhan Sokak No:6 Kat:1
Küçükbakkalköy - Ataşehir
İstanbul
Tel: +90 216 5770 898
Fax: +90 216 5770 898
E-Mail: info@esbe.com.tr
www.esbe.com.tr

Poland

ESBE Hydronic Systems Sp. z o.o.
ul. Garbary 56
PL-61-758 Poznań
Tel: +48 61 85 10 728
Fax: +48 61 85 82 208
E-Mail: info.pl@esbe.eu
www.esbe.pl



NO.1 IN HYDRONIC SYSTEM CONTROL