

Wall door stop

Knud Holscher Collection

d line

PRODUCT DATA SHEET

| ITEM NUMBER | SURFACE |
|----------------|--------------------------|
| 14.5055.02.001 | Satin Stainless Steel |
| 16.5055.01.001 | Polished stainless steel |

PRODUCT
Wall door stop Ø20x31 mm

PICTURE



TENDER TEXT

Wall door stop . Outstanding classic danish design by Knud Holscher.
Material: stainless steel AISI 316 satin finish. Radius: Ø20. W:20 mm x H:20 mm x D:31 mm.

PRODUCT SPECIFICATION

Dimensions: W:20 mm x H:20 mm x D:31 mm.
Radius:Ø20
Material: stainless steel AISI 316
Surface finish: satin grain 320, crafted by hand
Warranty for stainless steel (non movable) parts - 20 years

DRAWING

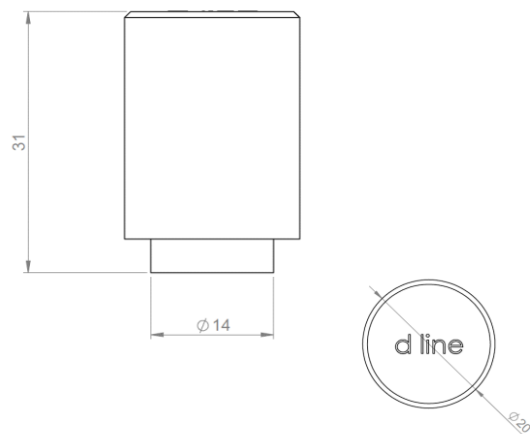

SPARE PARTS / ACCESSORIES:

MOUNTING:

See instruction supplied with the product

PACKING:

1pcs in a bag

ISO-DRAWING

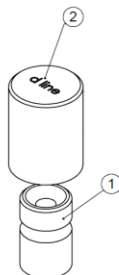

PRODUCT CARE

d line products are produced in the highest quality stainless steel, marine grade, AISI 316. To sustain the unique d line finish appearance please follow the below instructions:

- Wash down the surfaces using soapy water or mild detergent
- Always thoroughly rinse off with clean water
- To complete the cleaning procedure dry/polish the surfaces with a soft dry cloth

Please do not use scouring powder, steel wool, chloride based detergents or other aggressive cleaning products as these may damage the surface.

If spots or corrosion appear on the surface it is not due to the stainless steel quality, but to impurities in the environment, aggressive conditions or improper or insufficient cleaning.